



# INSTALLATION INSTRUCTIONS

Accessory  
**AUTOMATIC DAY/NIGHT MIRROR**

Application  
**2011 CR-Z**

Publications No.  
**All 43553**  
Issue Date  
**AUG 2010**

## PARTS LIST

**Attachment Kit  
P/N 08V03-SZT-100**

Automatic day/night mirror harness

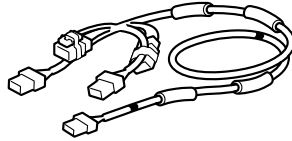

EPT sealer

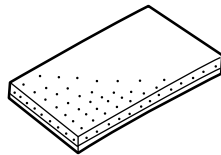

Clip



5 Wire ties

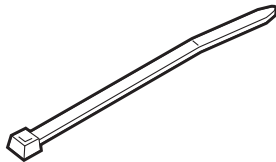

Fuse label

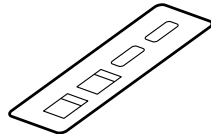

Harness cover

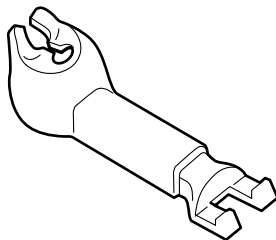

**Automatic Day/Night Mirror Kit  
P/N 08V03-TA0-100A**

Automatic day/night mirror

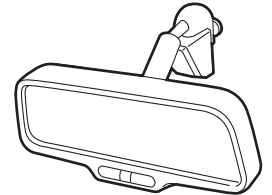

Spring



Operating Instructions

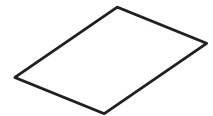

## TOOLS AND SUPPLIES REQUIRED

Phillips screwdriver

Ratchet

8 mm and 10 mm Sockets

Isopropyl alcohol

Shop towel

Diagonal cutters

Needle nose pliers

10 mm Open end wrench

Rubber mallet

Trim Tool Set (T/N SOJATP2014)

(Available through the Honda Tool and Equipment program. On the iN, click on: Service/Service Bay/Tool and Equipment Program, then enter the number under "Search." Or call 888-424-6857.)

Flat-tip screwdriver

Masking tape

**Illustration of the Automatic Day/Night Mirror Installed on the Vehicle**

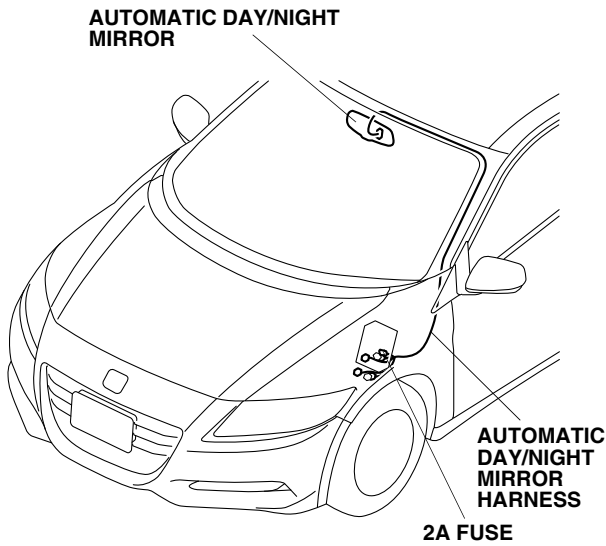

**INSTALLATION**

**Customer Information:** The information in this installation instruction is intended for use only by skilled technicians who have the proper tools, equipment, and training to correctly and safely add equipment to your vehicle. These procedures should not be attempted by “do-it-yourselfers.”

1. Make sure you have the anti-theft codes for the audio unit and navigation system (if equipped), then write down the radio station presets.
2. Disconnect the negative cable from the battery.

3. Using a plastic trim tool, remove the left and right lens from the map light console (four retaining tabs for each lens).

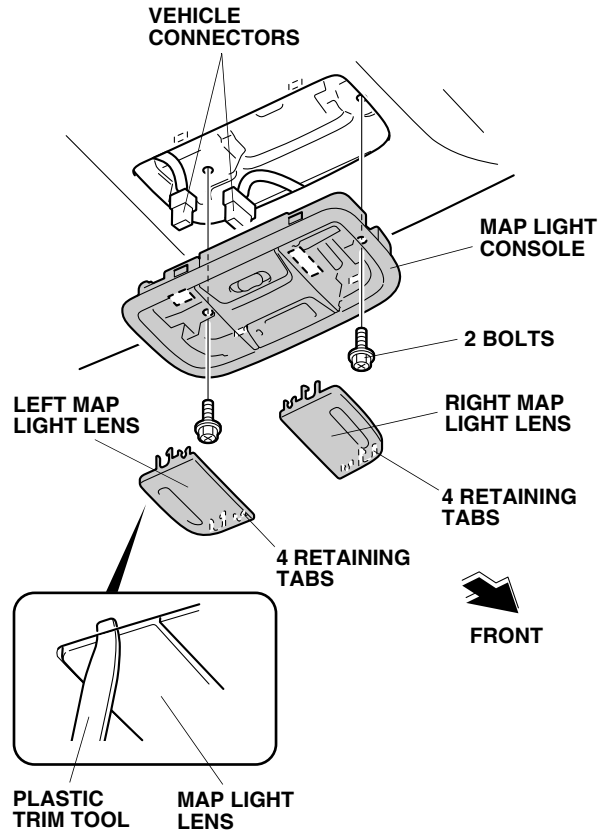

4. Remove the map light console (two bolts and unplug the vehicle connectors).
5. Remove the rearview mirror from the mirror holder by rotating the stay 90° clockwise.

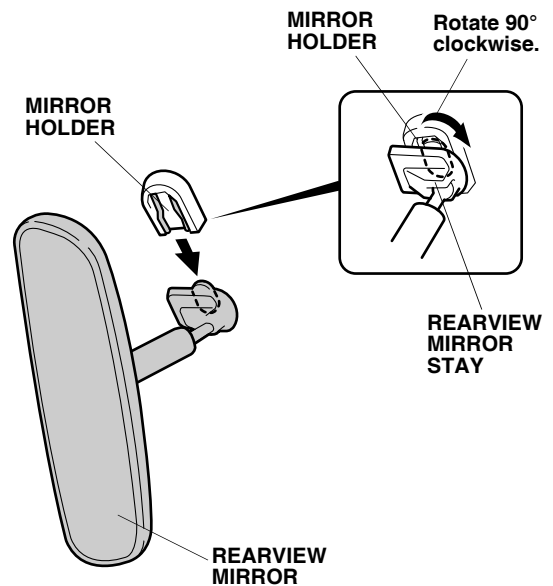

- Turn the left sunvisor toward the driver's seat.

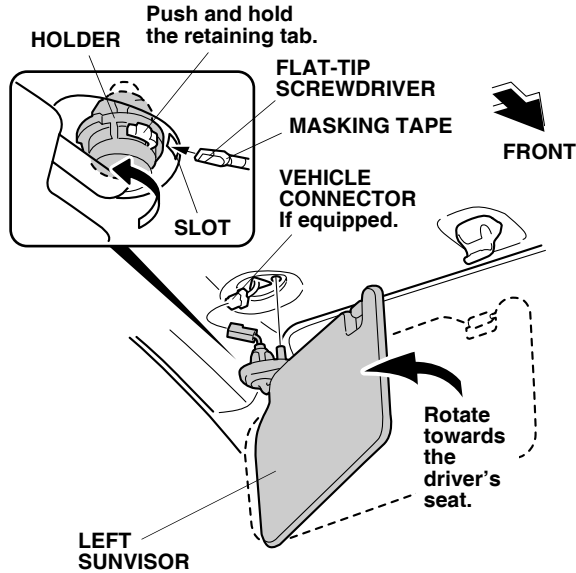

- Locate the slot in the sunvisor holder, and insert a flat-tip screwdriver wrapped with masking tape into the slot. Push and hold the retaining tab.
- While holding the retaining tab, push up on the left sunvisor, and rotate it towards the door to release the sunvisor, then remove the left sunvisor.  
NOTE: If the retaining tab did not stay pushed in, return the left sunvisor to its original position and repeat steps 7 and 8.
- Using a flat-tip screwdriver wrapped with masking tape, release the three retaining tabs on the left sunvisor holder.

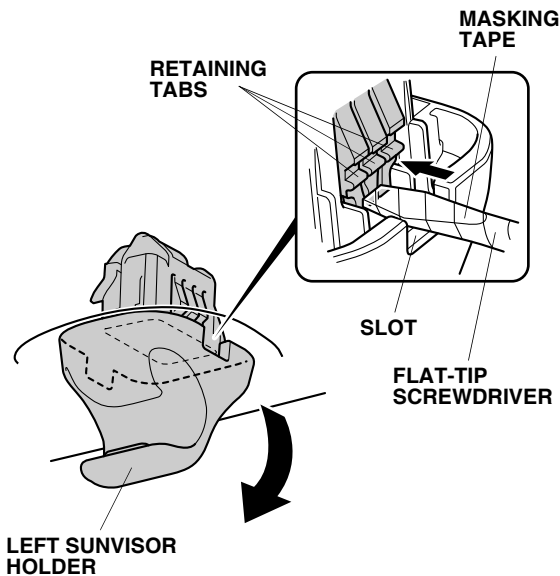

- While holding down the sunvisor holder as shown, use a flat-tip screwdriver wrapped with masking tape to remove the left sunvisor holder (three retaining tabs).

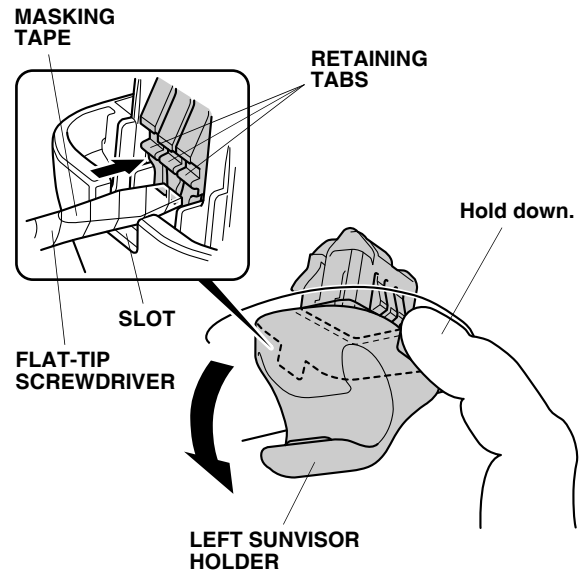

- Pull away the door seal from around the driver's A-pillar trim.

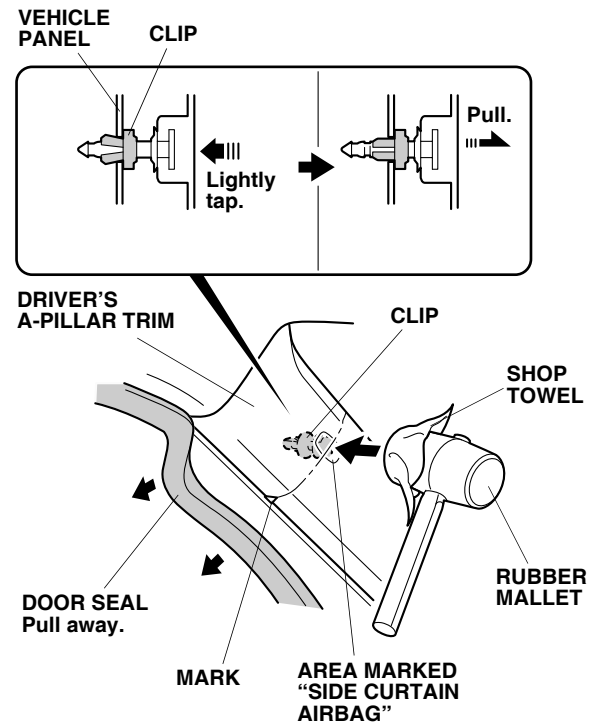

- Using a rubber mallet wrapped with a shop towel, lightly tap the area marked "SIDE CURTAIN AIRBAG" on the top of the driver's A-pillar trim to push in the clip. Make sure to strike the area perpendicular to the vehicle.

13. Remove the driver's A-pillar trim (two clips).

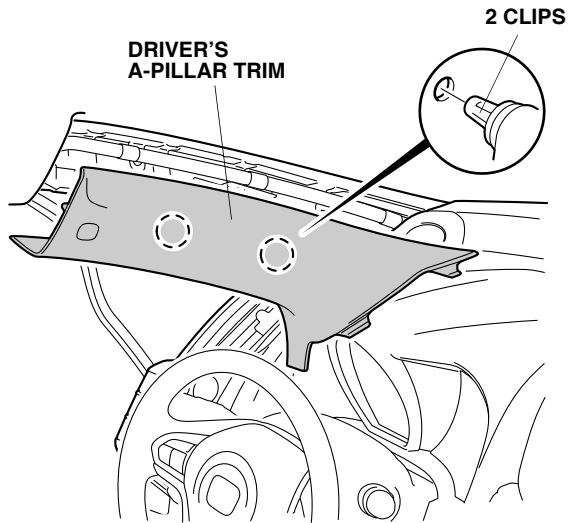

14. Remove the fuse box cover (four retaining tabs).

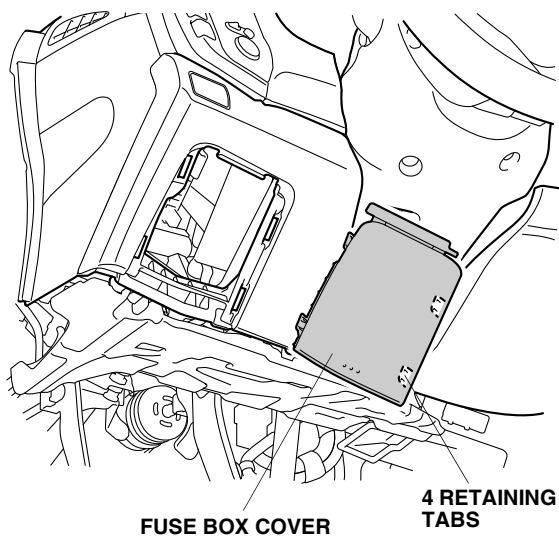

15. Remove the driver's under cover (turn the knob, two clips, and one pin).

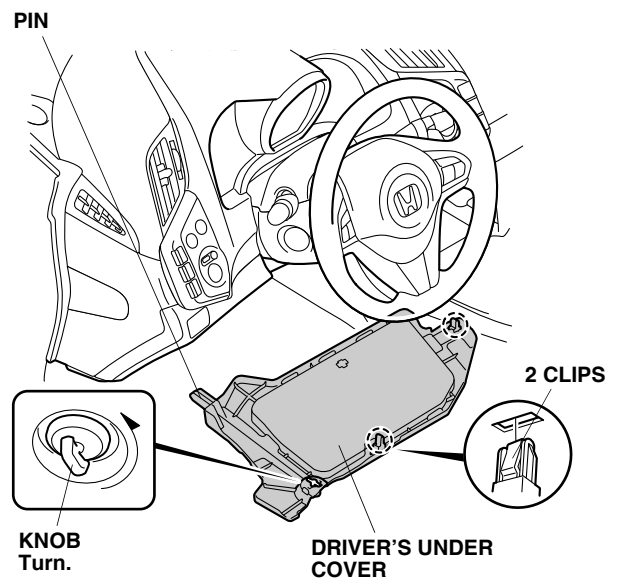

16. Pull away the door seal from around the driver's kick panel, and remove the driver's kick panel (two clips and three retaining tabs). If the vehicle is equipped with foot well lights, unplug the vehicle connector.

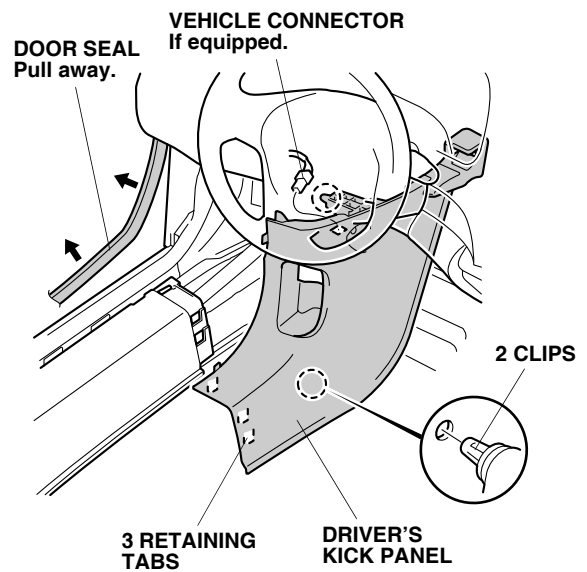

17. Using needle nose pliers, remove the vehicle spring, and install the new spring into the mirror holder.

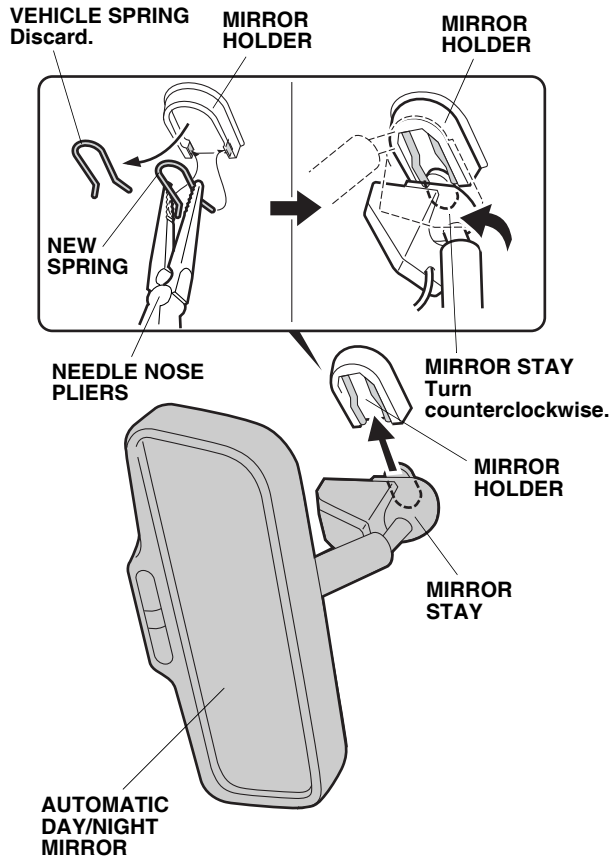

18. Slide the automatic day/night mirror stay onto the mirror holder, and turn the mirror stay counterclockwise to secure the automatic day/night mirror.

19. Using isopropyl alcohol on a shop towel, thoroughly clean the fuse case where the fuse label will attach. Attach the 2A fuse label to the fuse case on the automatic day/night mirror harness.

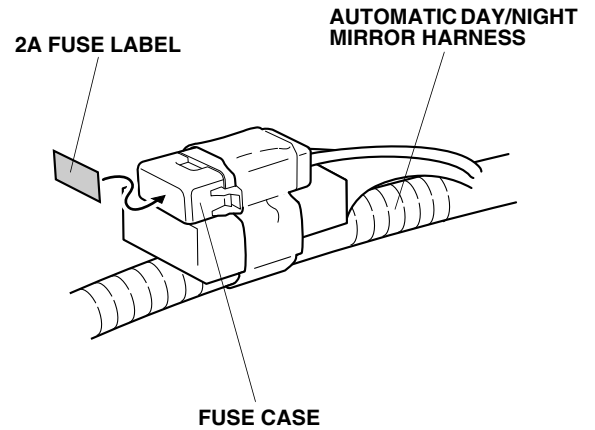

20. At the fuse box, unplug the vehicle 8-pin connector. Plug the automatic day/night mirror harness 8-pin connector into the fuse box 8-pin connector. Plug the vehicle 8-pin connector into the automatic day/night mirror harness 8-pin connector as shown.

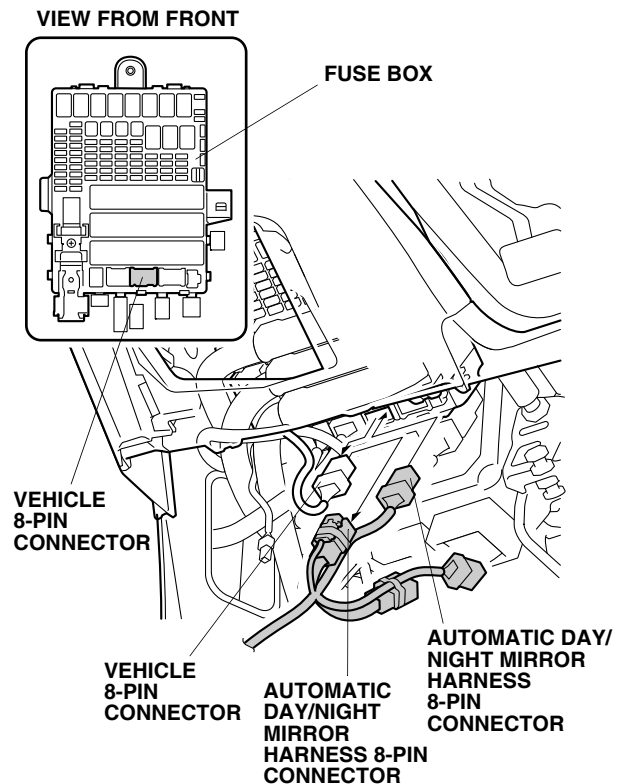

- Unplug the vehicle 12-pin connector from the fuse box, and plug the automatic day/night mirror harness 12-pin connector into the fuse box 12-pin connector. Plug the vehicle 12-pin connector into the automatic day/night mirror harness 12-pin connector as shown.

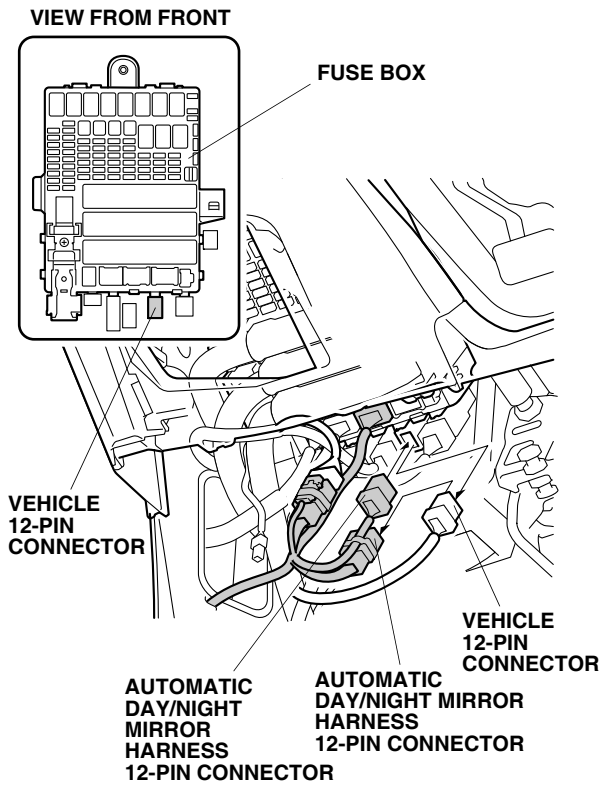

- Secure the automatic day/night mirror harness to the vehicle harness with one wire tie.

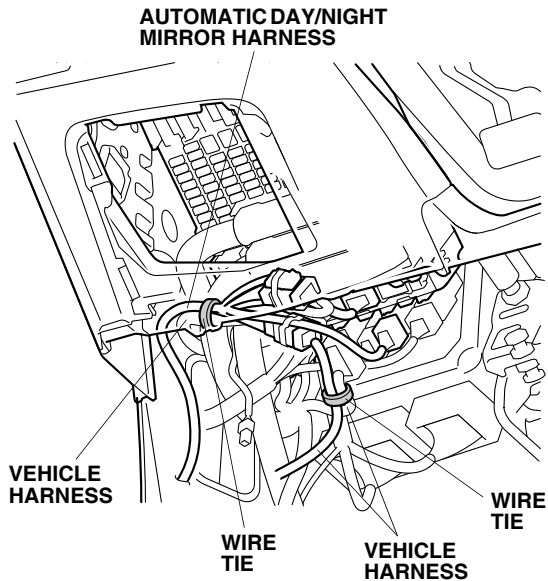

- Secure the vehicle harness to the vehicle harness with one wire tie.

- Pull away the door seal from around the dashboard.

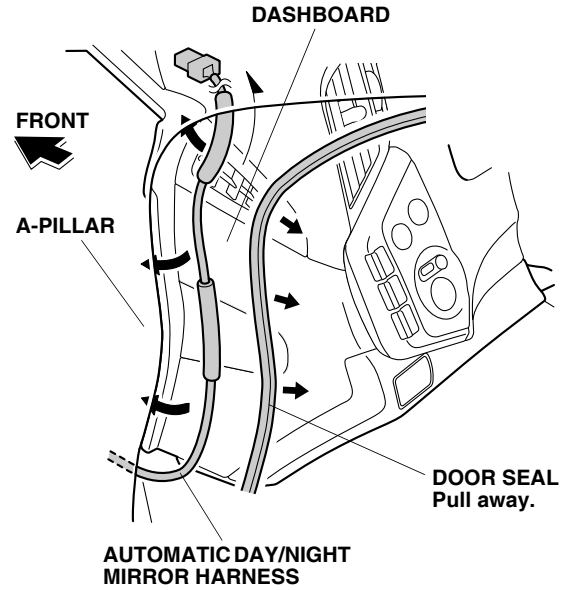

- Insert the automatic day/night mirror harness between the dashboard and the A-pillar.
- Align the green tape on the automatic day/night mirror harness with the vehicle clip, and secure the automatic day/night mirror harness to the vehicle harness with three wire ties.

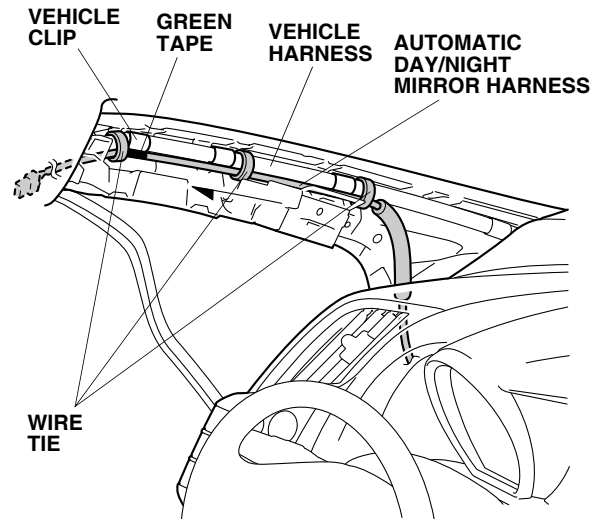

27. Route the automatic day/night mirror harness under the headliner as shown. Be careful not to crease the headliner.

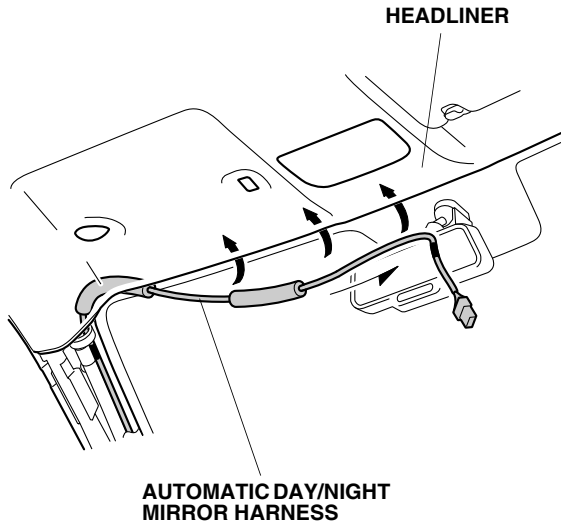

28. Plug the automatic day/night mirror harness 7-pin connector into the automatic day/night mirror.

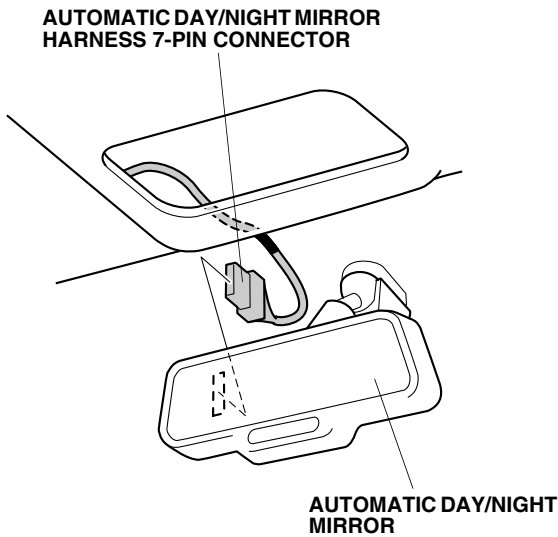

29. Align the green tape on the automatic day/night mirror harness at the headliner. Route the automatic day/night mirror harness through the grooves on the harness cover. Secure the harness cover to the mirror stay.

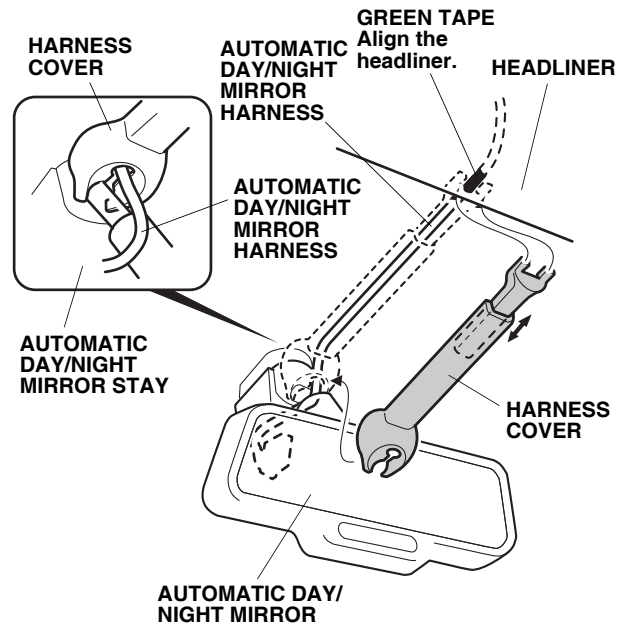

30. Slide the end of the harness cover under the headliner.
31. Using isopropyl alcohol on a shop towel, thoroughly clean the area where the EPT sealer will attach. Secure the automatic day/night mirror harness to the vehicle panel with one EPT sealer as shown.

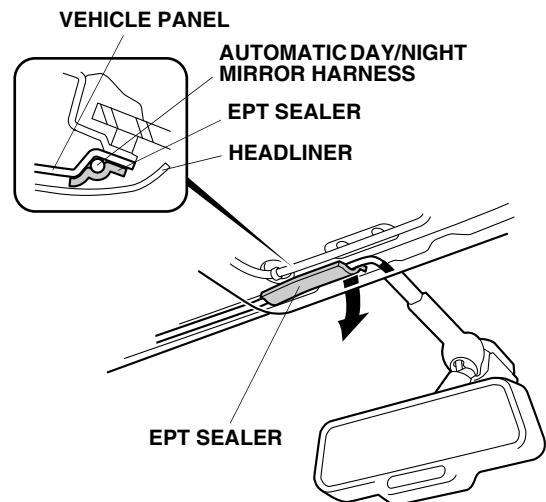

32. Remove and discard the vehicle clip from the driver's A-pillar trim, and install the new clip.

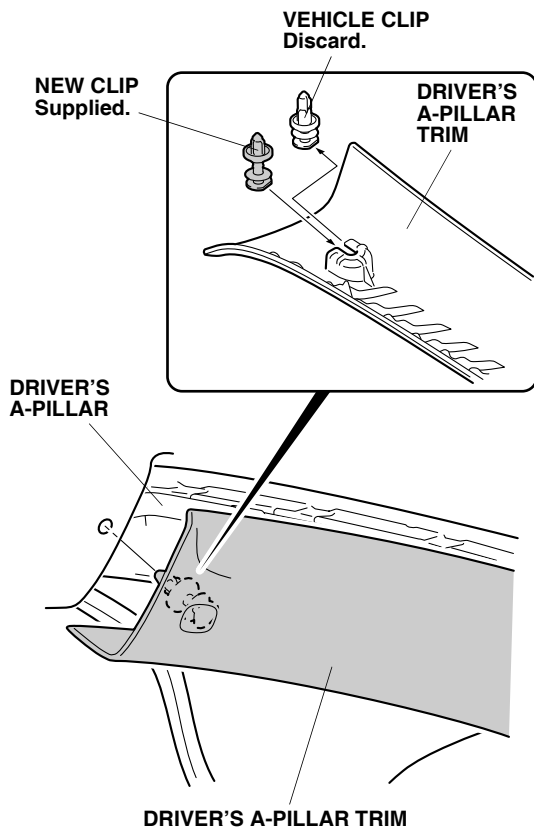

33. Reinstall the driver's A-pillar trim.
34. Check that all wire harnesses are routed properly and all connectors are plugged in.
35. Reinstall all removed parts.
36. Reconnect the negative cable to the battery.
37. Enter the customer's audio and navigation system (if equipped) anti-theft codes, and reset the radio station presets.
38. Reset the clock.
39. If the IMA battery level gauge display is at zero, start the engine, and hold it between 3,500 rpm and 4,000 rpm (without load) in P or N position until the IMA battery level gauge display shows at least half-charged.

**NOTE:**

- Check the operation of the automatic day/night mirror according to the Operating Instructions supplied.
  - Adjust the zone and calibrate as required.
40. Put the Operating Instructions in the glove box.

**Function Check**

1. Turn the ignition switch to ON (II), but do not start the engine.

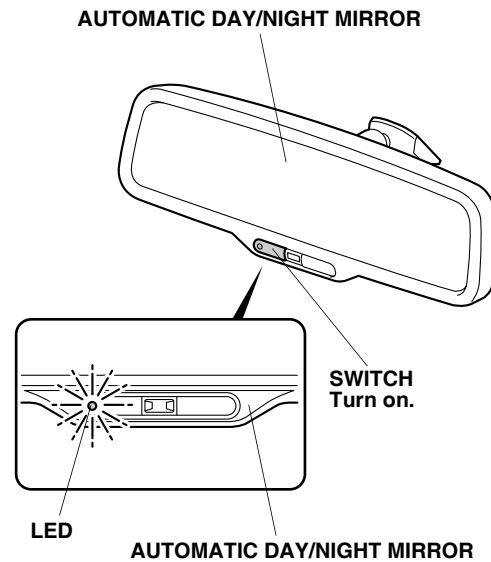

2. Turn the switch on. Check that the LED glows properly.
3. Cover the front sensor on the automatic day/night mirror with your hand, and use a flash-light to light the rear sensor on the automatic day/night mirror. Check to make sure the mirror surface dims.

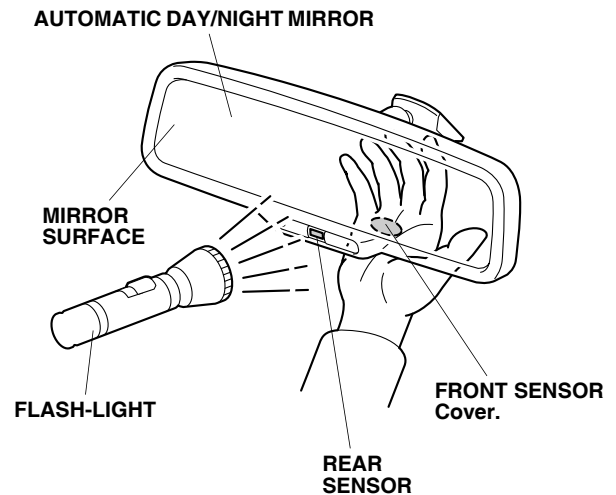

4. Step on the brake pedal, and move the shift lever to the "R" position. Repeat step 3, and check to make sure the mirror surface does not dim.
  - Make sure that the parking brake is locked securely.
  - If the automatic day/night mirror does not function properly, check the fuse and all connectors, including the ground cable.