



INSTALLATION INSTRUCTIONS

<p>Accessory</p> <p>FENDERWELL TRIM P/N 08P21-SHJ-100</p>	<p>Application</p> <p>ODYSSEY</p>	<p>Publications No.</p> <p>All 27345</p>
		<p>Issue Date</p> <p>SEP 2004</p>

NOTE: Fenderwell trims cannot be installed on a vehicle equipped with a front nose mask.

PARTS LIST

Left front fenderwell trim

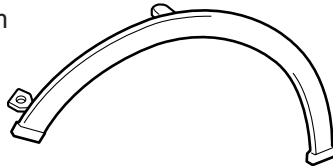

Right front fenderwell trim

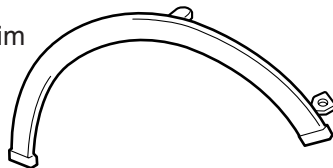

Left rear fenderwell trim

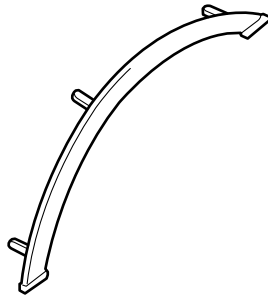

Right rear fenderwell trim

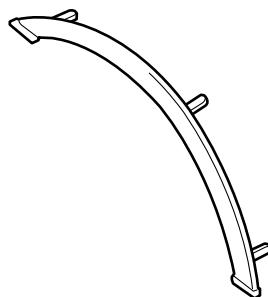

2 Inner protector

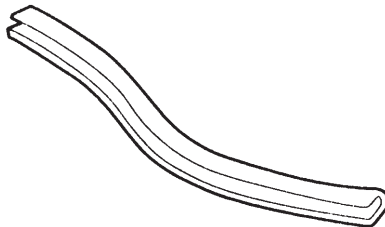

TOOLS AND SUPPLIES REQUIRED

Flat-tip screwdriver

Pliers

Rubber mallet

Shop towel

Liquid dishwashing soap and water

INSTALLATION

NOTE:

- These installation instructions show the left fenderwell trims being installed; the same procedure applies to installing the right fenderwell trims.
- Each fenderwell trim is identified by a label attached to the inside surface.

Installing the Front Fenderwell Trims

1. Turn the steering wheel all the way counterclockwise.
2. Remove the expansion clip that secures the inner fender. Push in on the inner fender to release the clip.

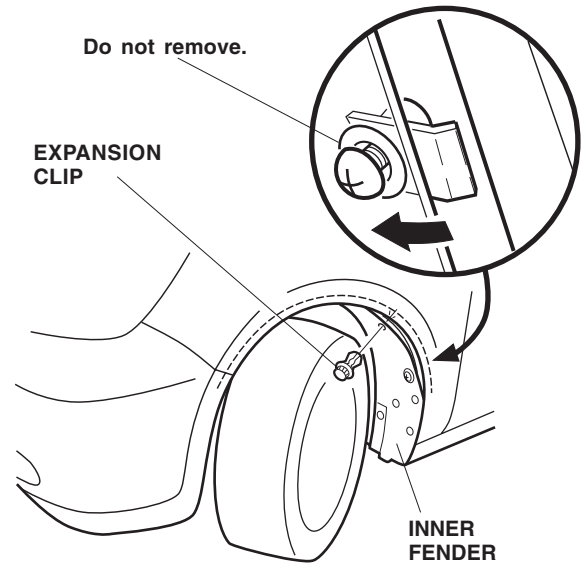

3. Clean the area to be covered, and wax it with a high-quality paste wax.

- Pull the inner fender down, and position the fenderwell trim between the inner fender and the fender flange.

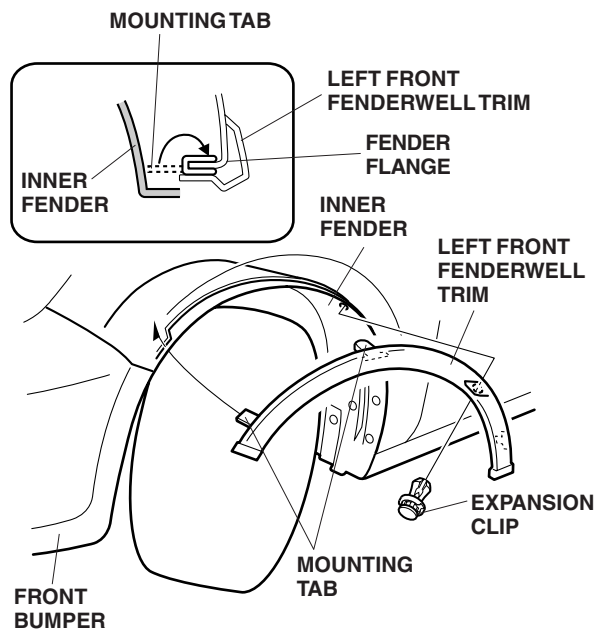

- While holding the left front fenderwell trim firmly against the fender, squeeze the two mounting tabs around the fender flange as shown. If necessary, use pliers over a shop towel to bend the mounting tabs around the fender flange.
- Attach the left front fenderwell trim and the inner fender to the front fender with expansion clip removed in step 1.
- Turn the steering wheel all the clockwise and repeat steps 1 through 6 to install the right front fenderwell trim.

Installing the Rear Fenderwell Trims

- Position the left rear fenderwell trim on the fender flange, and align the rear of the fenderwell trim with the rear bumper. While holding the fenderwell trim firmly against the fender, bend the three mounting tabs around the fender flange.

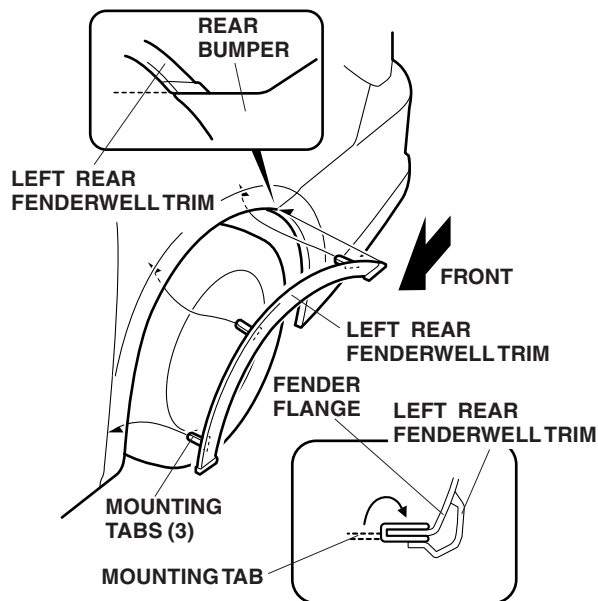

- Using a rubber mallet, install the inner protector over the fender flange and fenderwell trim.

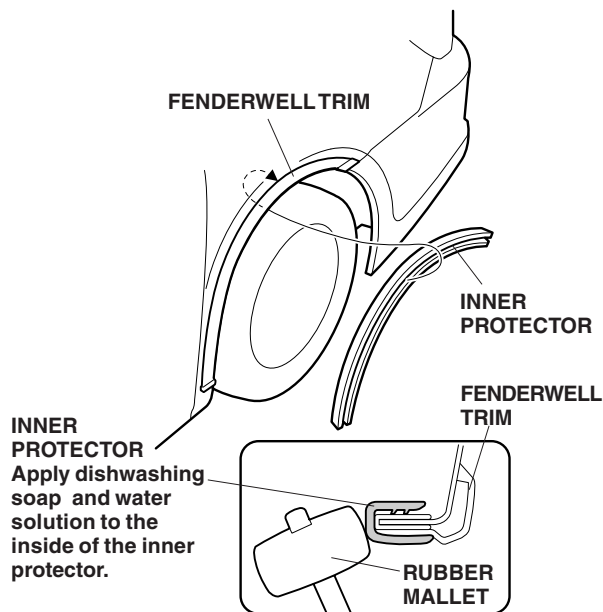

- Repeat steps 8 and 9 to install the left rear fenderwell trim.