

PARTS LIST

Center console

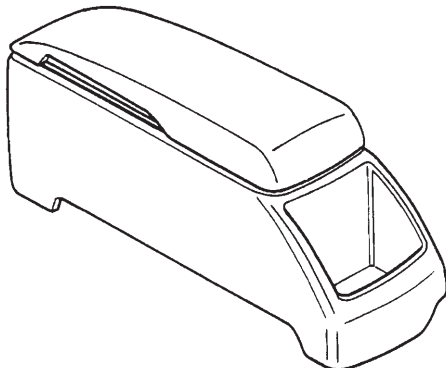

Bracket A

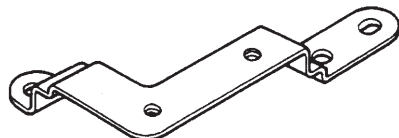

Bracket B

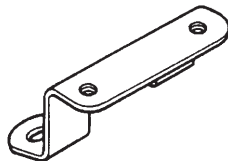
Plate
(jack nut tightening tool)3 Washer-screws,
6 x 25 mm4 Washer-screws,
5 x 16 mm

3 Jack nuts



3 Butyl O-rings

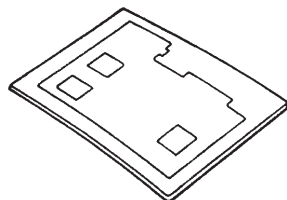

Template

**TOOLS AND SUPPLIES REQUIRED**

Phillips screwdriver

Utility knife

Felt-tip pen (water soluble)

Eye protection (face shield, safety goggles, etc.)

Drill

6 mm and 11 mm Drill bits

Center punch

Touch-up paint

Tape measure

INSTALLATION

Before You Begin:

- To install the center console, you need to move both front seats completely to the front.
- Be extremely careful not to damage the parking brake lever cover and the center console.

1. Remove the caps from the front of the parking brake lever cover and remove the two self-tapping screws concealed under the caps. Remove the cover by sliding it toward the rear.

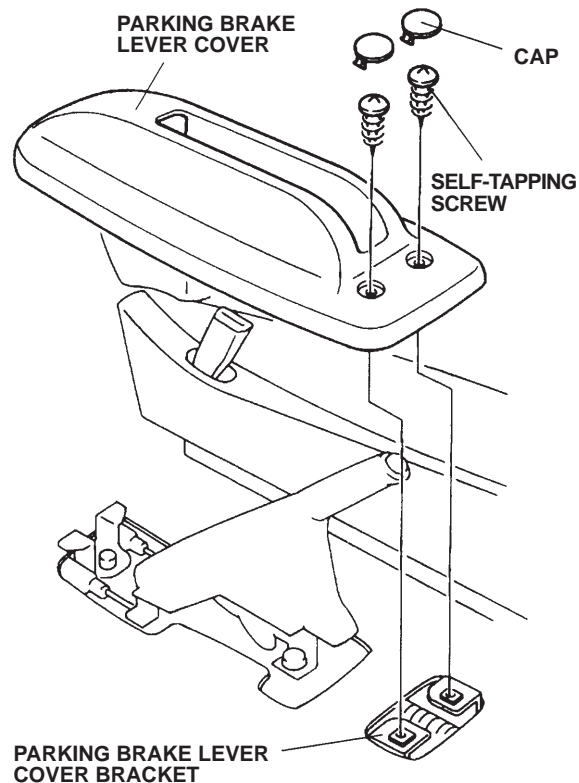

2. Measure and mark the floor carpet. Using a utility knife, cut the floor carpet along three sides as indicated by the heavy line. Cut both the carpet and the insulation under the carpet.

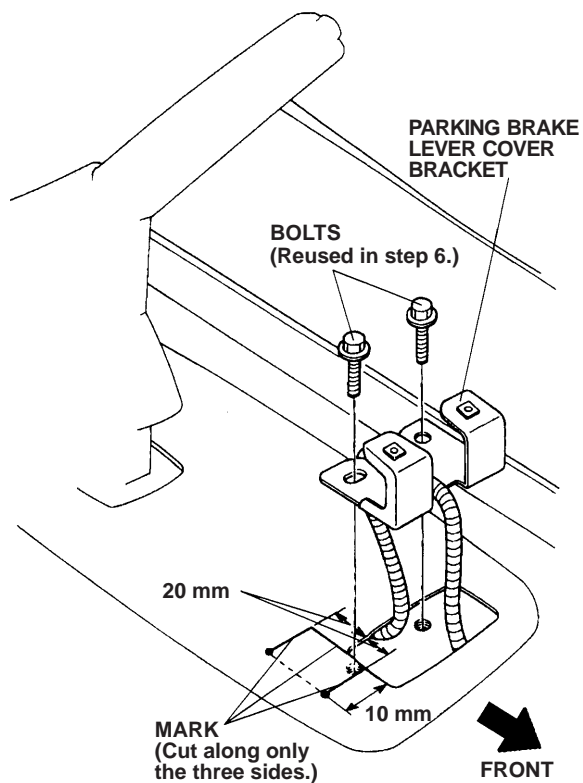

3. Remove the two bolts fastening the parking brake lever cover to the floor panel.
4. Using scissors, cut out the template. Using a utility knife, cut out the square holes in the template. Position the template on the carpet on the right side of the parking brake lever.

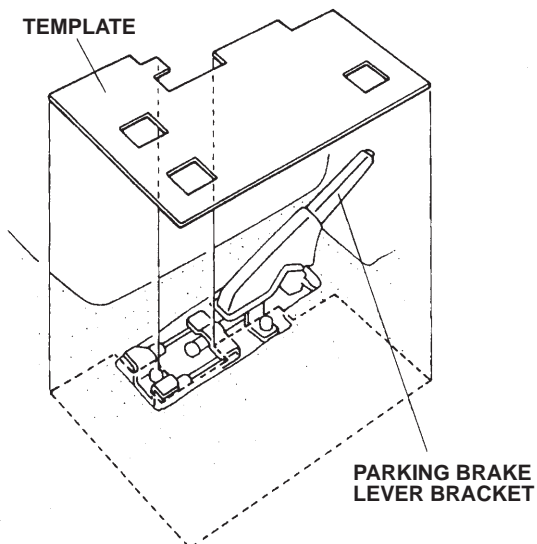

5. Mark the floor carpet at each of the three square holes. Remove the template from the floor carpet. Using a utility knife, cut the floor carpet and mat at each mark along only its three sides as indicated by the heavy lines and the dotted line.

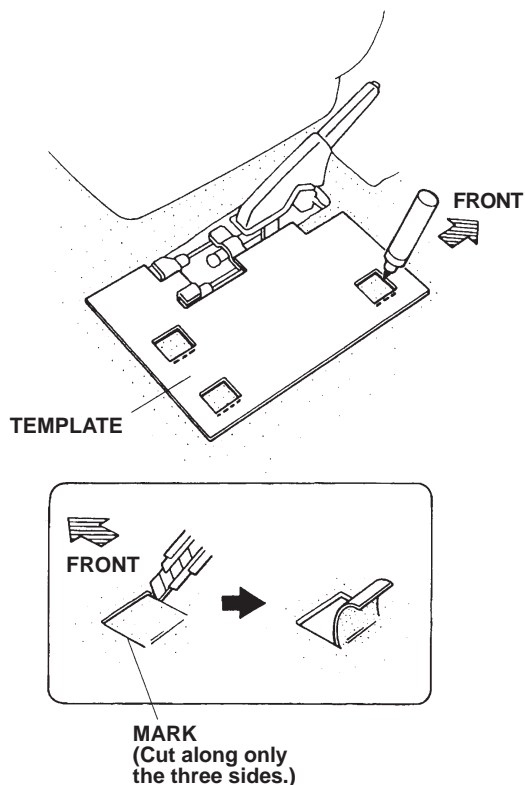

6. Turn over the floor carpet at each cut, then slide bracket A under the parking brake lever bracket. Align their holes and install the two bolts removed in step 3, do not tighten them yet.

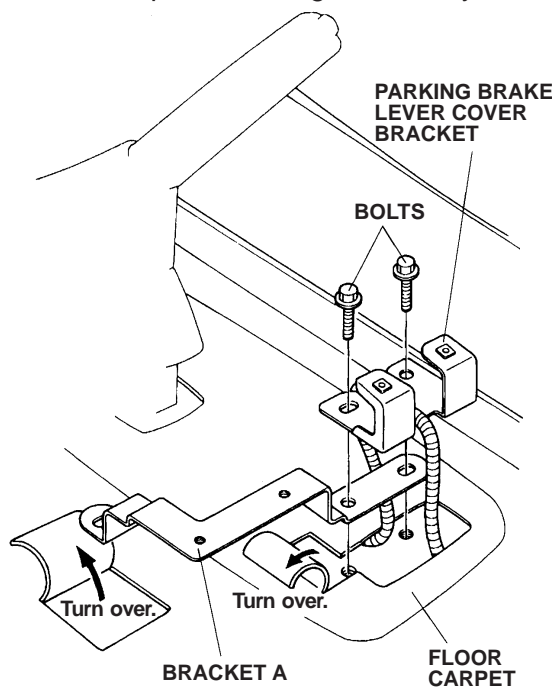

7. Mark the floor panel at the center of the hole in bracket A with a felt-tip pen, and lightly center-punch the mark.
8. Remove the two bolts, and remove bracket A.
9. While wearing eye protection, drill an 11 mm hole through the center-punched mark. First drill a 6 mm pilot hole, then finish with an 11 mm bit.

NOTE: The jack nut cannot be secured on the floor panel if the diameter of the hole exceeds 11 mm.

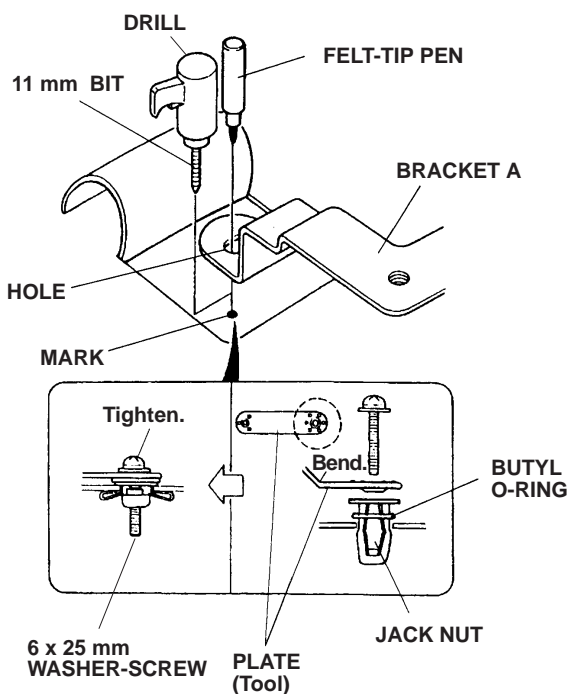

10. Remove all burrs, and apply touch-up paint.
11. Bend the plate (tool) at its center. Slide the butyl O-ring onto the jack nut, then insert the nut into the predrilled 11 mm hole. Using the tool, install and tighten the 6 x 25 mm washer-screw. The jack nut will be secured on the floor panel as it is tightened with the tool.
12. Remove the 6 x 25 mm washer-screw and the plate (tool).

13. Reinstall the parking brake lever cover bracket and bracket A on the floor panel using the two bolts removed in step 8 and the 6 x 25 mm washer-screw you just removed.

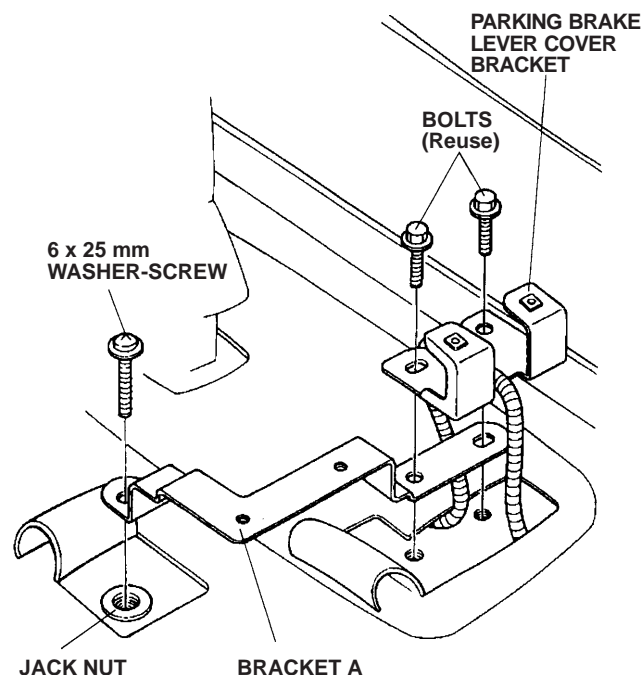

14. Turn over the floor carpet at each cut behind the parking brake lever. Position bracket B on the floor panel, and align its left hole with the punch mark on the floor panel.

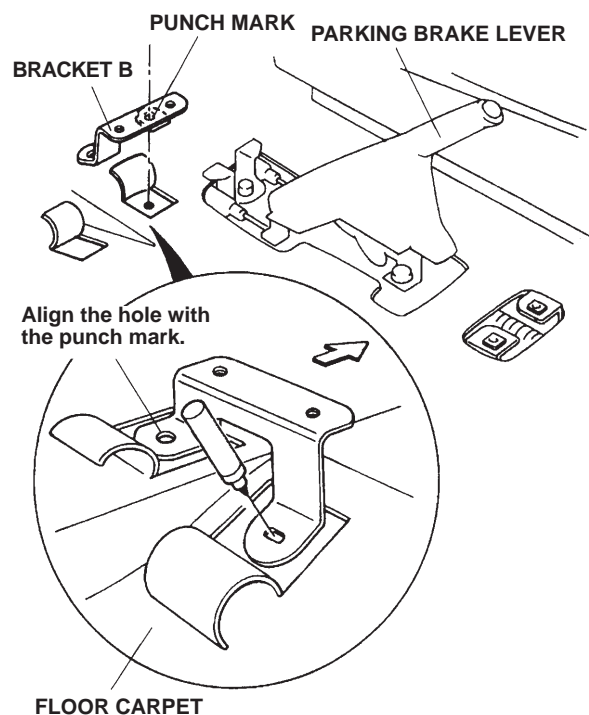

15. Mark the floor panel at the right hole in bracket B. Remove bracket B, and lightly center-punch the mark. While wearing eye protection, drill an 11 mm hole through the two center-punched marks. First drill a 6 mm pilot hole, then finish with an 11 mm bit.

NOTE: The jack nuts cannot be secured on the floor panel if the diameter of the holes exceeds 11 mm.

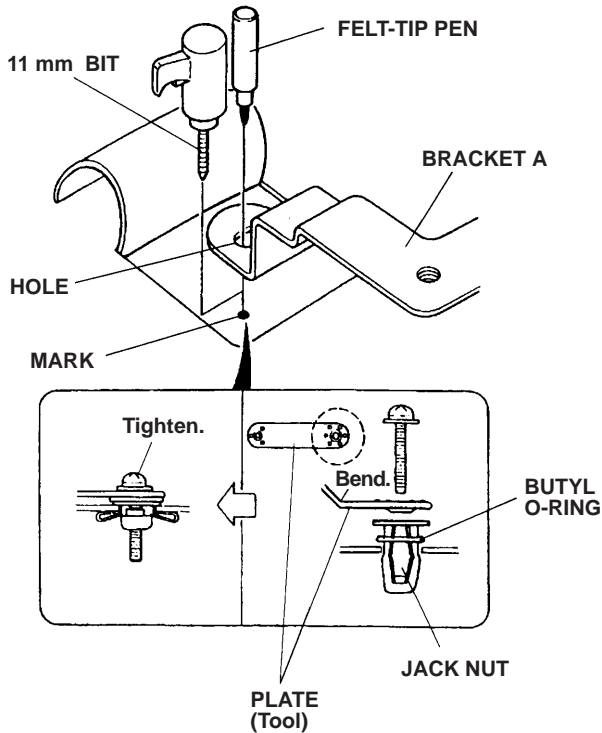

16. Remove all burrs and apply touch-up paint.
17. Slide the butyl O-ring onto each jack nut, then insert the jack nuts into the 11 mm holes you just drilled. Using the plate (tool), install a 6 x 25 mm washer-screw in each jack nut and tighten the washer-screws.
18. Remove the two 6 x 25 mm washer-screws and the plate (tool).

19. Position bracket B on the floor panel, and install the two 6 x 25 mm washer-screws.

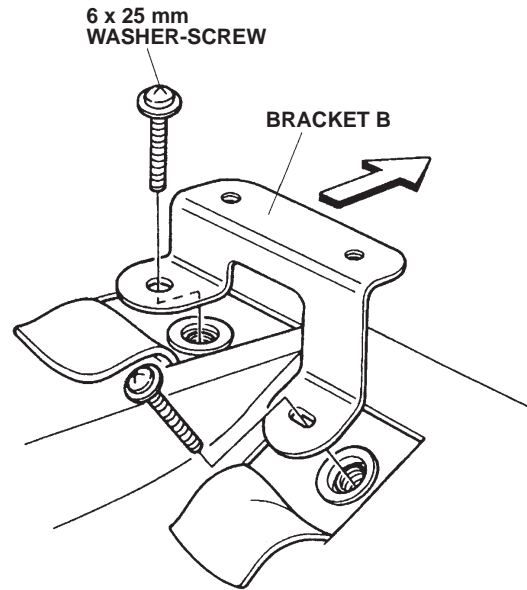

20. Reinstall the parking brake lever cover.

21. Position the center console on brackets A and B, and install the four 5 x 16 mm washer-screws.

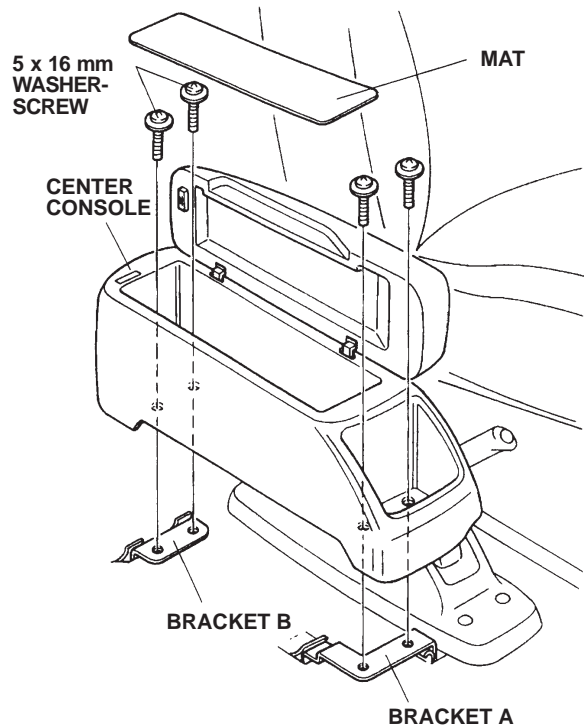

22. Install the mat in the center console.