

ACURA
INSTALLATION
INSTRUCTIONS

Accessory
FOG LIGHTS
P/N 08V31-S6M-212

Application

Publications No.
BII 30236
Issue Date
JULY 2005

PARTS LIST

Left fog light



Right fog light



Left fog light trim



Right fog light trim



Left bracket

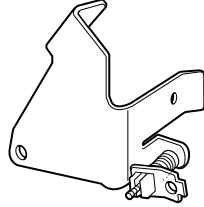

Right bracket

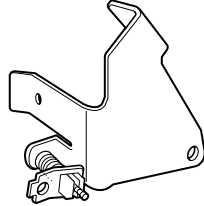

Switch harness

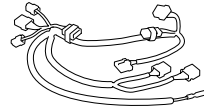

Fog light harness



Left subbracket

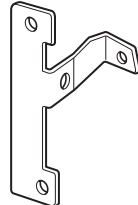

Right subbracket

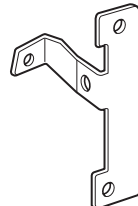

Switch

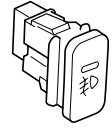

4 Stepped screws



2 Washer-screws, 4 x 8 mm

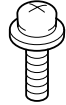

2 Washer-bolts, 5 x 12 mm

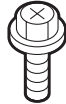

8 Washer-screws, 5 x 16 mm



8 Spring nuts



Relay

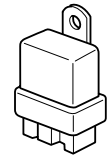

Washer-bolt, 6 x 12 mm



2 Lock washers



24 Wire ties

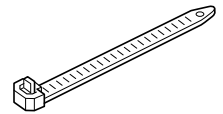

Wire tie with clip

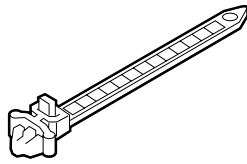

Fuse label

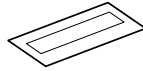

TOOLS AND SUPPLIES REQUIRED

Phillips screwdriver

8 mm and 10 mm Combination wrenches

Ratchet

10 mm Socket

Illustration of Fog Lights Installed on the Vehicle

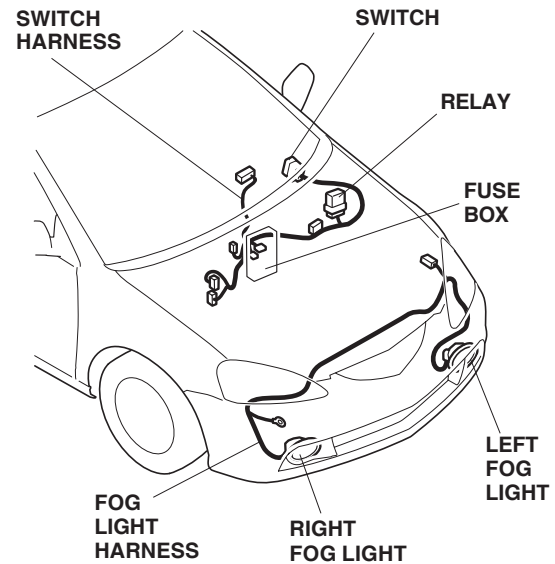

INSTALLATION

Customer Information: The information in this installation instruction is intended for use only by skilled technicians who have the proper tools, equipment, and training to correctly and safely add equipment to your vehicle. These procedures should not be attempted by “do-it-yourselfers.”

NOTE: If you're also installing a front under spoiler, install the fog lights first.

1. Make sure you have the anti-theft code for the radio, then write down the radio station presets.
2. Disconnect the negative cable from the battery.

Routing the Fog Light Harness

3. Disconnect the positive (+) cable from the battery, and release the clip from the holder bolt.

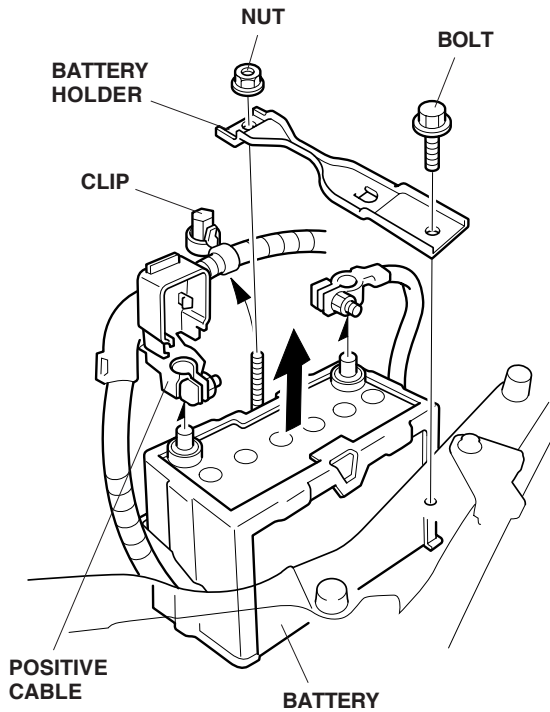

4. Remove the bolt and the nut that fasten the battery holder, and remove the holder and the battery.
5. Remove the left lid from the front bumper (two retaining tabs and one hook). Repeat on the right lid.

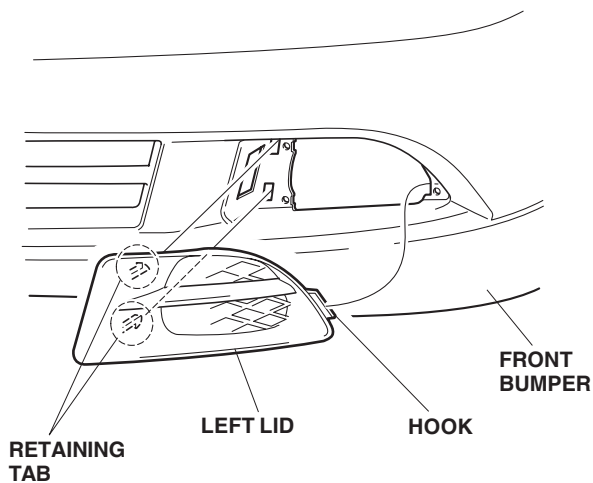

6. Remove the two self-tapping screws and one clip, then pull the left front inner fender out in the direction shown. Repeat on the right front inner fender.

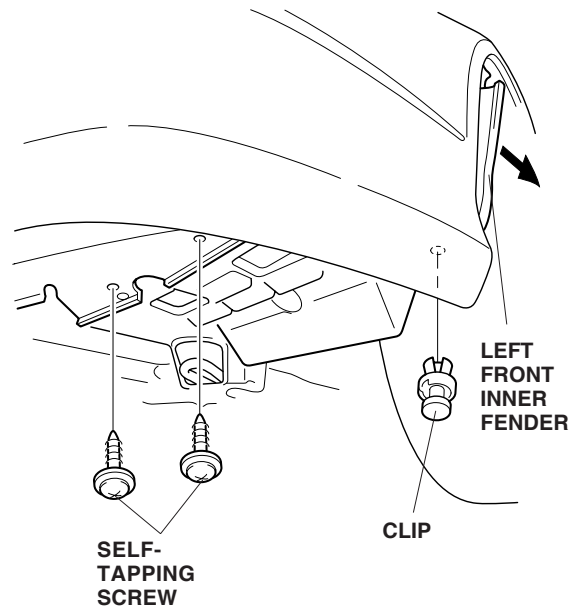

- Remove the windshield washer tank filler neck clip from its holder.

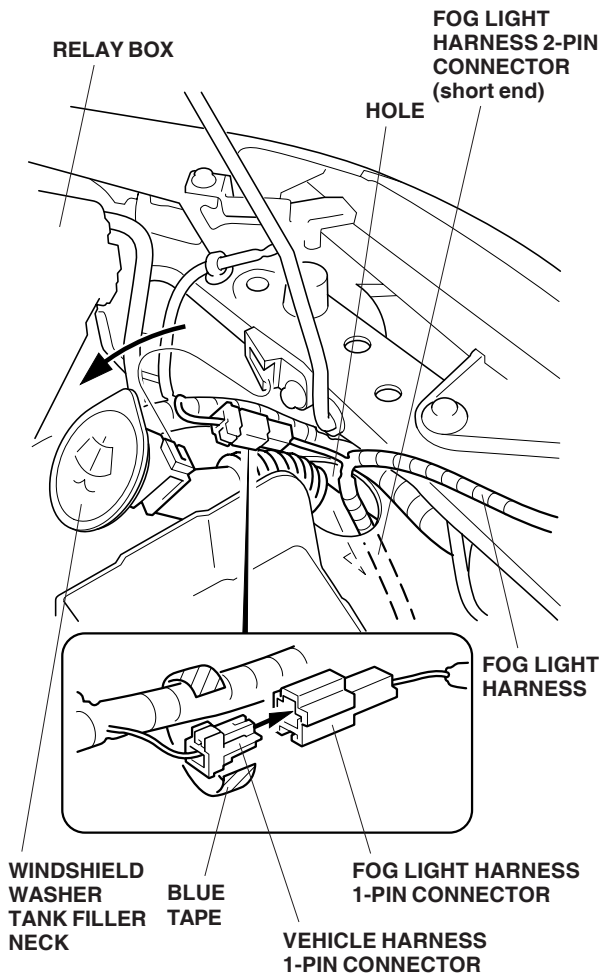

- Locate the 1-pin connector blue-taped to the vehicle harness routed under the relay box, and remove the blue tape to free the connector.
- Connect the 1-pin connector of the fog light harness to the 1-pin connector of the vehicle harness you just freed.
- Route the fog light harness 2-pin connector (short end) down into the front bumper through the same hole as the windshield washer tank filler neck.

- Route the fog light harness 2-pin connector (long end) along the vehicle harness behind the left headlight and inside of the bulkhead upper frame toward the right (passenger's) side of the vehicle. Make sure the 2-pin connector is in front of the bulkhead center stay.

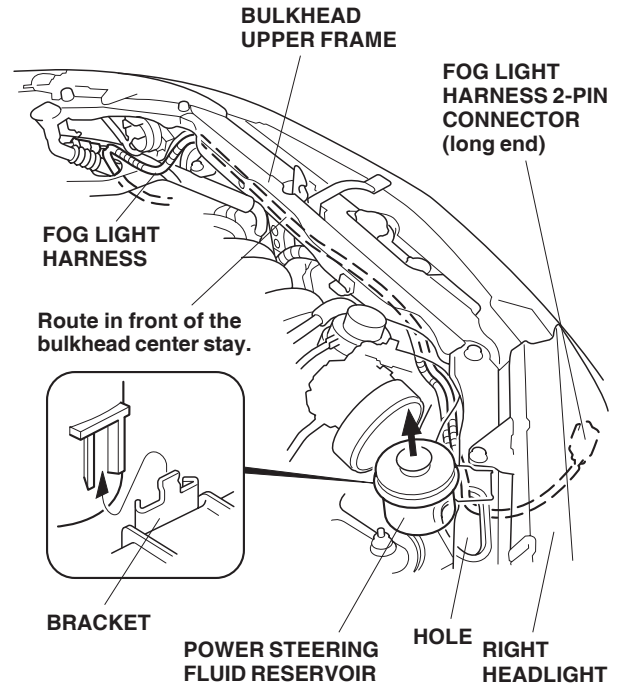

- Remove the power steering fluid reservoir. Continue routing the fog light harness 2-pin connector behind the right headlight along the vehicle harness, then hang it down into the front bumper through the hole at the rear of the right headlight.

- Secure the fog light harness 1-pin connector connected behind the left headlight to the vehicle harness with one wire tie.

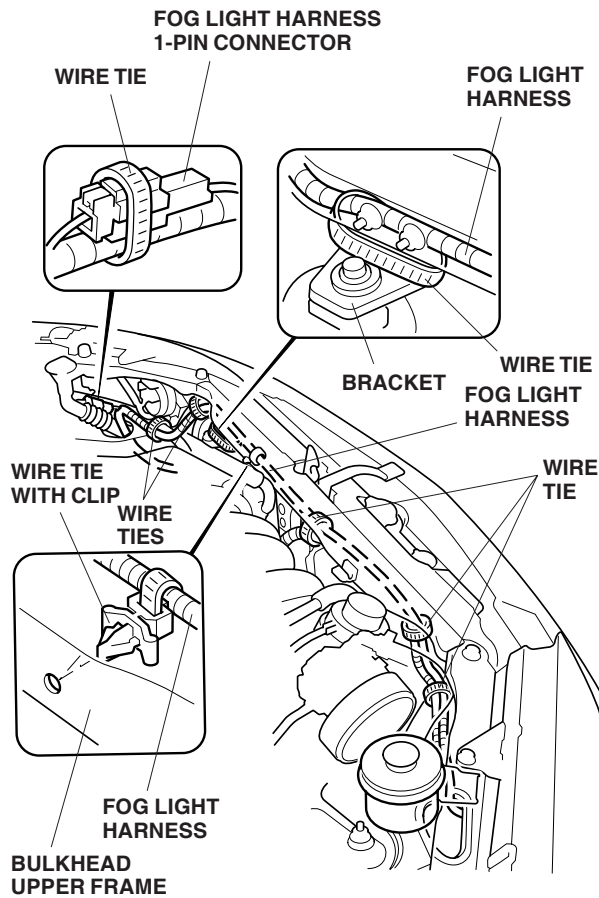

- Secure the fog light harness to the vehicle harness and the bracket on the left (driver's) side of the vehicle using three wire ties in the areas shown.
- Secure the fog light harness to the hole in the bulkhead upper frame with the wire tie with clip.
- Secure the fog light harness to the vehicle harness along the front bulkhead with three wire ties.

- Pull out on the right front inner fender, and remove the vehicle ground bolt from the right front side frame. Secure the ground terminal of the fog light harness with this ground bolt.

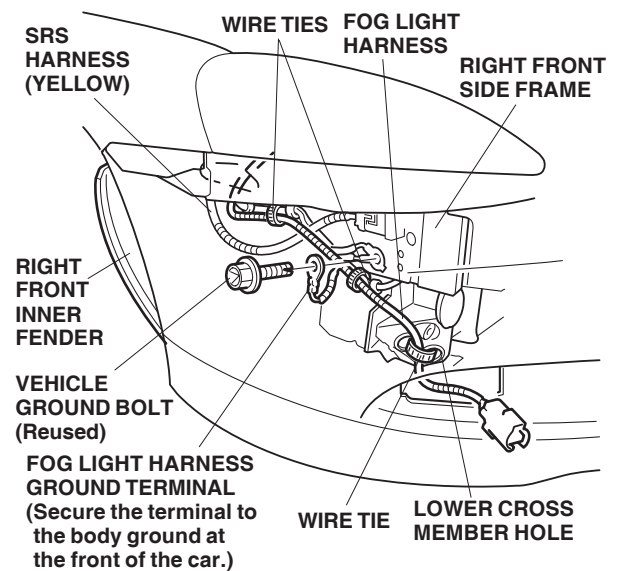

- Secure the fog light harness to the vehicle harness with two wire ties. Do not secure the fog light harness to the SRS harness.
- Secure the fog light harness to the hole in the right lower cross member with one wire tie.
- Pull out on the left front inner fender, and secure the fog light harness to the vehicle harness with three wire ties.

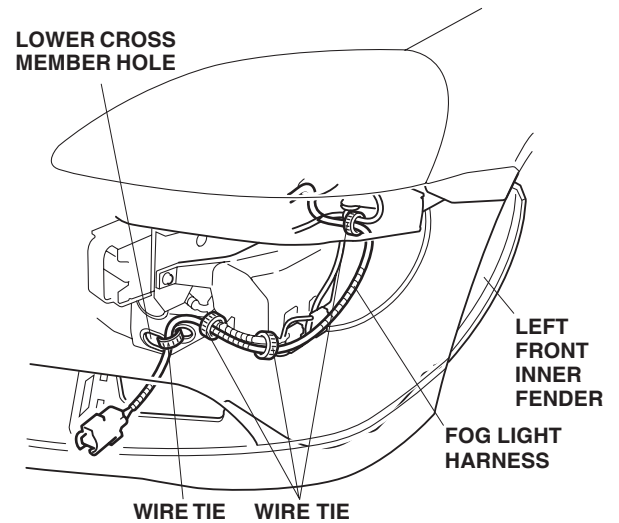

- Secure the fog light harness to the hole in the left lower cross member and to the vehicle harness with one wire tie.

Installing the Fog Lights

22. Position the left bracket and left subbracket on the left fog light, and install two stepped screws (one for each) and one 4 x 18 mm washer-screw. Check the identification mark on the brackets (R: right, L: left).

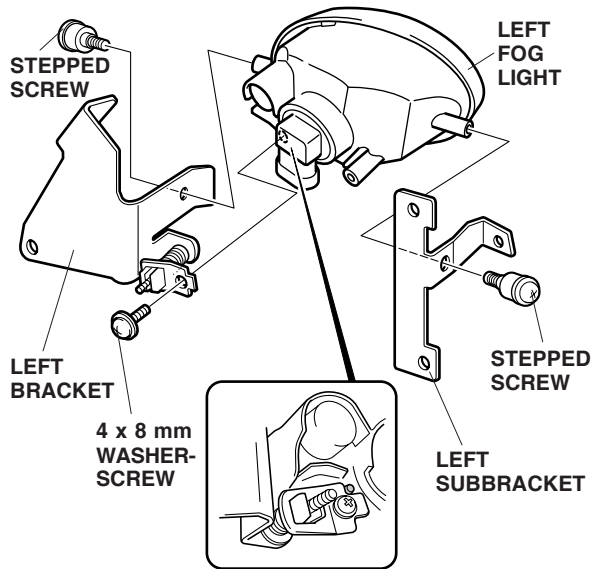

23. Slide four spring nuts onto the opening at the left side of the front bumper.

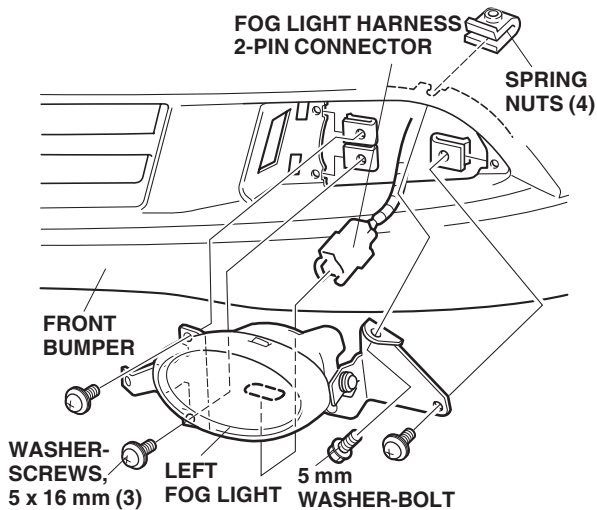

24. Pull out the fog light harness 2-pin connector and plug it into the left fog light. Position the left fog light on the front bumper, and install three 5 x 16 mm washer-screws and one 5 x 12 mm washer-bolt.
25. Repeat steps 22 thru 24 on the right side to install the right fog light.

26. Install the tab on the outboard side of the left fog light trim into the slot in the front bumper.

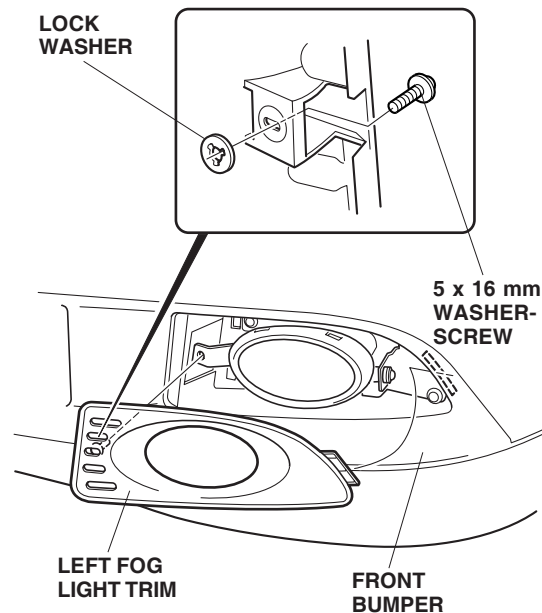

27. Insert one 5 x 16 mm washer-screw into the hole in the left fog light trim in the position shown, and secure the trim with one lock washer from the reverse side.
28. Repeat steps 26 and 27 on the right side to install the right fog light trim.

Routing the Fog Switch Harness

29. Inside the vehicle, turn the two knobs counterclockwise, and remove the driver's dashboard lower cover (two retaining tabs and two hooks).

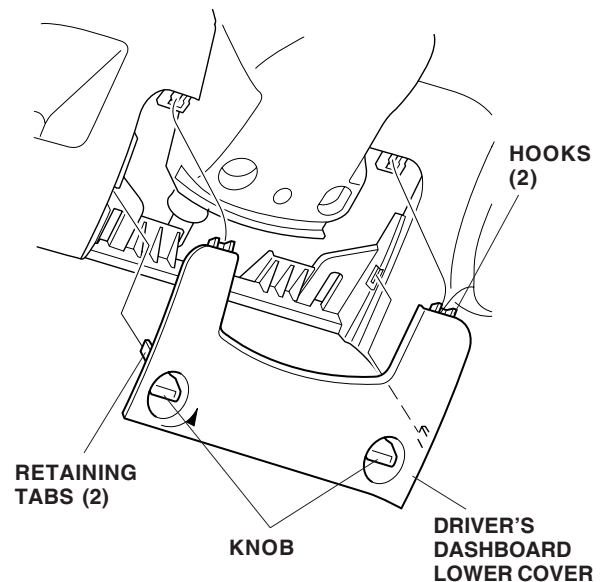

30. Turn the knob clockwise, and remove the driver's dashboard under cover from the holder (one clip).

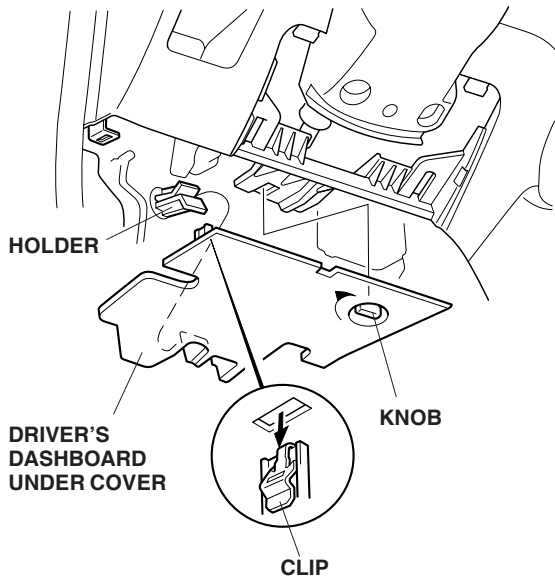

31. Pull the center lower cover toward you to release the one retaining tab and six clips.

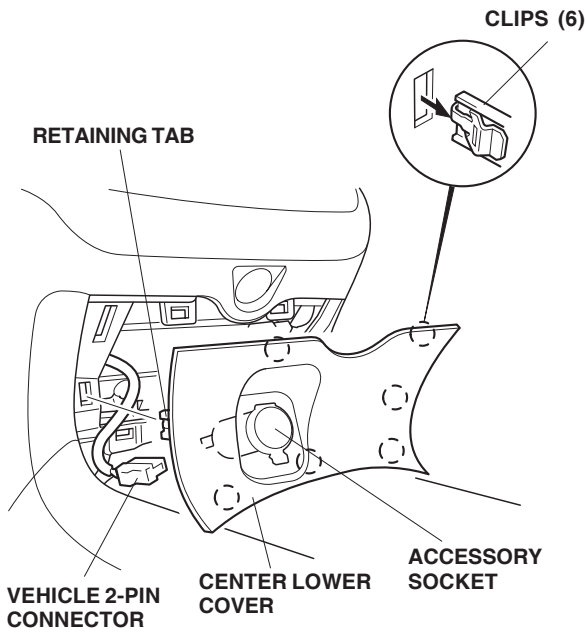

32. Unplug the vehicle 2-pin connector from the accessory socket, and remove the center lower cover.

33. On M/T vehicles, push the boot down while holding the plastic clip. Remove the shift knob by turning it counterclockwise.

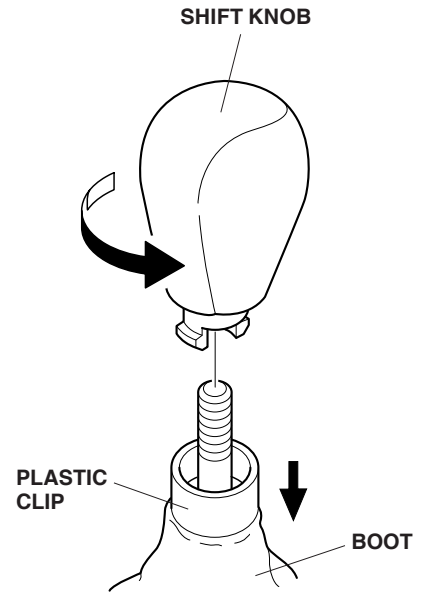

34. On A/T vehicles, remove the trim ring from the center console (four retaining tabs).

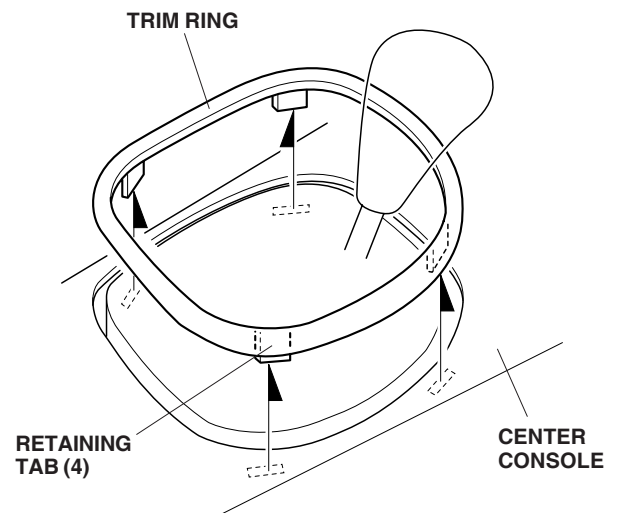

35. Remove the center console trim by lifting it upward to release the six clips and one retaining tab.

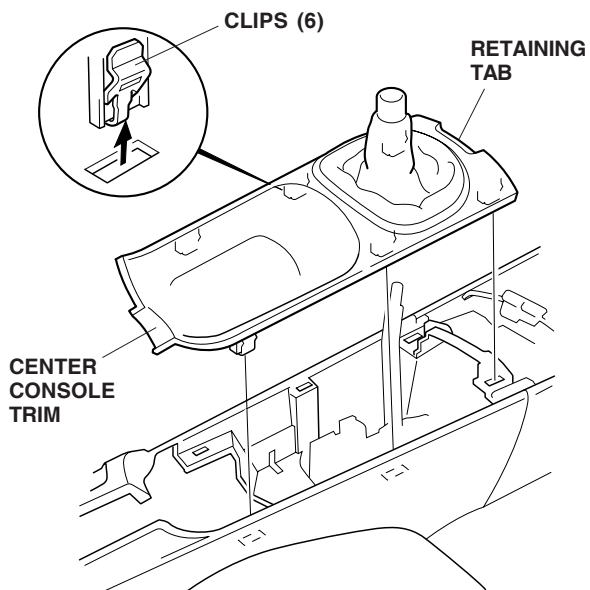

36. Remove the two self-tapping screws that fasten the center console.

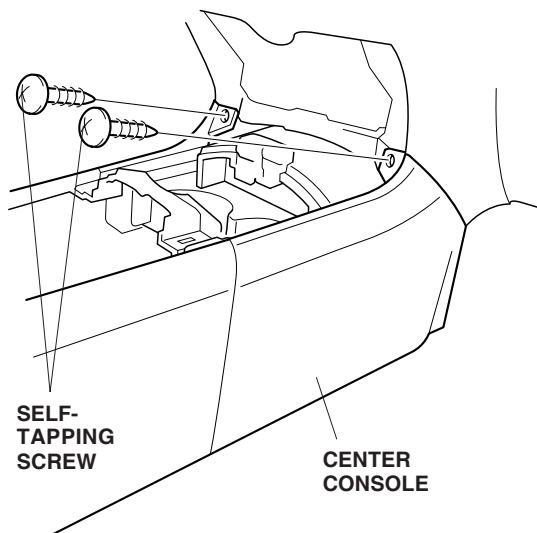

37. Remove the beverage holder by lifting it upward to release the four clips.

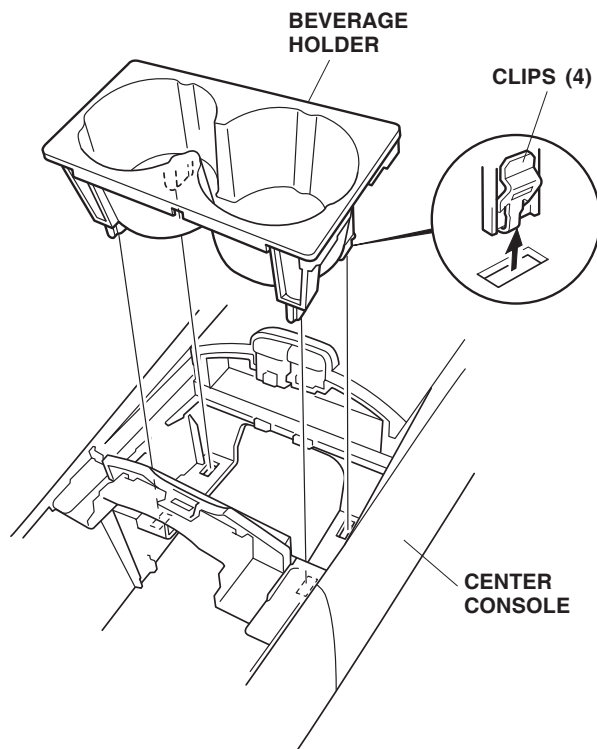

38. Inside the center console, remove the two clips. At the rear of the center console, remove the two screws.

M/T Vehicles:

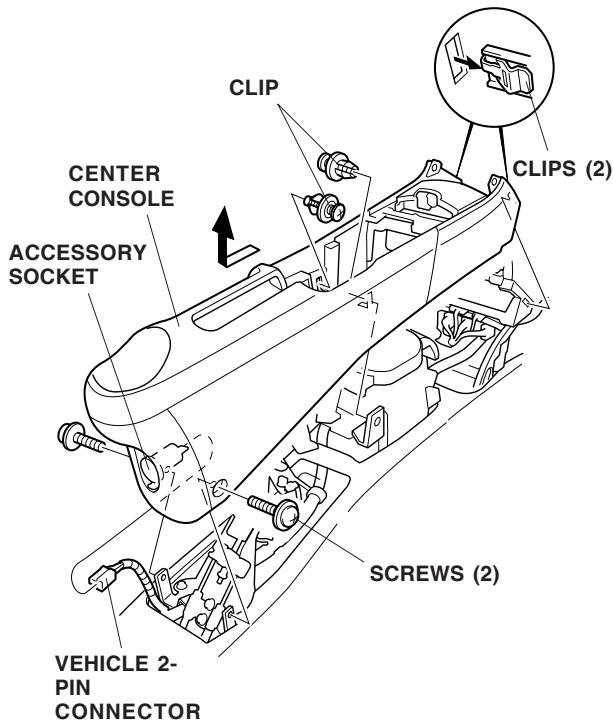

39. Release the two clips that secure the front of the center console, then disconnect the vehicle 2-pin connector from the accessory socket by first sliding the center console toward the rear, then lifting it upward. On A/T models, remove the covers at the front of the center console (one self-tapping screw for each cover).

A/T Vehicles:

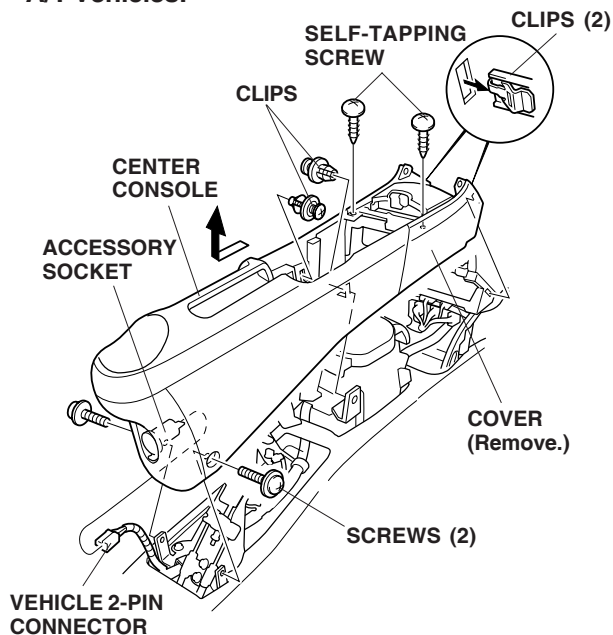

40. Remove the two self-tapping screws and one screw, and remove the steering column upper and lower covers (six retaining tabs).

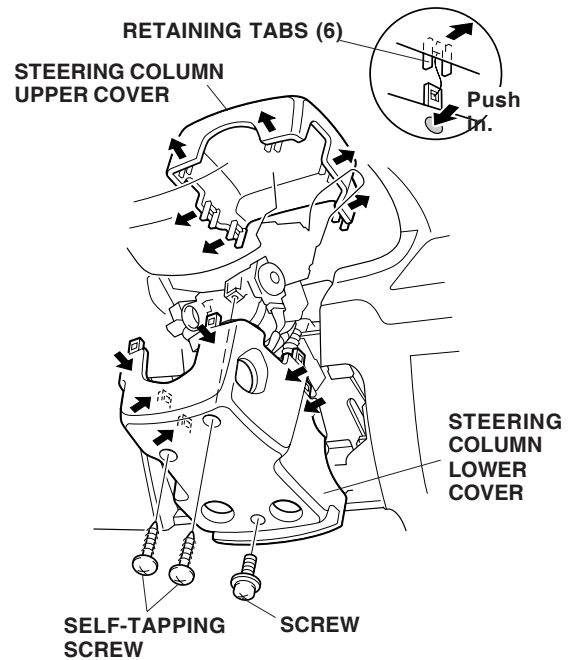

41. From behind the instrument panel, remove the right switch cover (two retaining tabs).

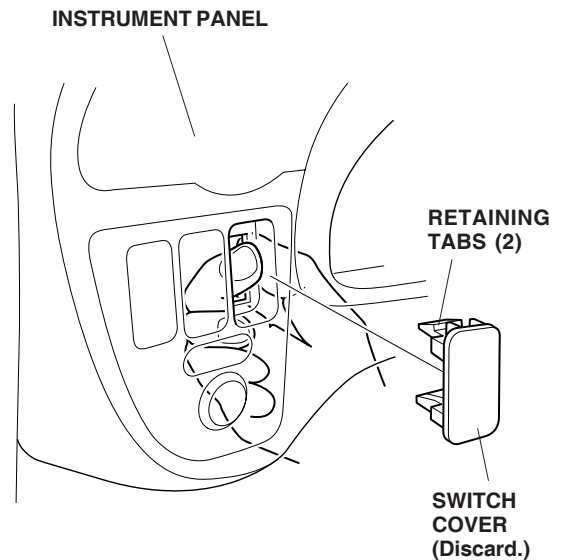

42. Remove the bolt that secures the fuse box, and lower the fuse box.

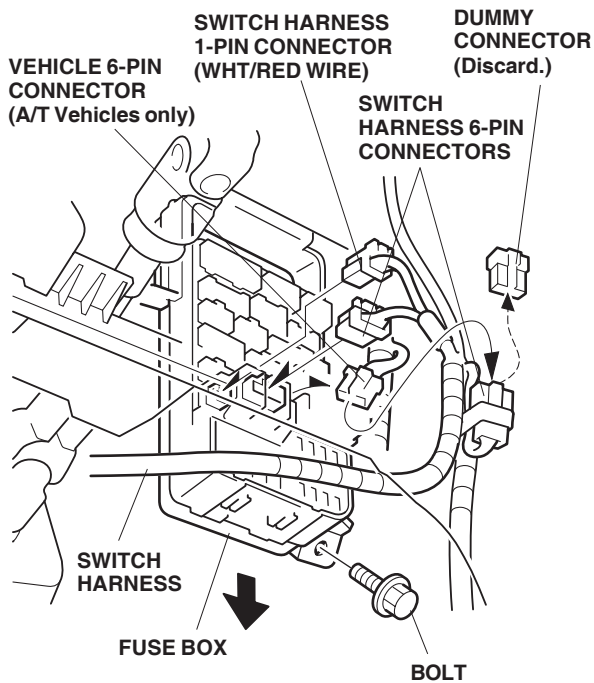

Location of 6-pin Connector

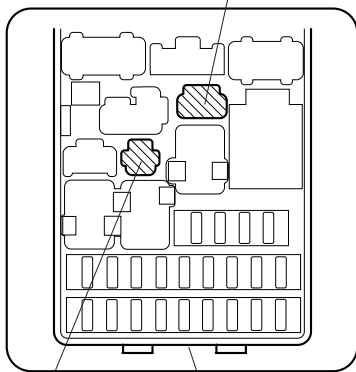

Location of 1-pin Connector FUSE BOX

43. Unplug the vehicle 6-pin connector from the fuse box, then plug the 6-pin connector of the switch harness there. Plug the 1-pin connector (WHT/RED wire) of the switch harness into the fuse box as indicated. On M/T vehicles, there is no 6-pin connector plugged into the fuse box.
44. On A/T vehicles, locate the 6-pin connector taped to the switch harness, and remove the dummy connector from that connector. Plug the vehicle 6-pin connector you just unplugged from the fuse box into that connector.

If the vehicle is equipped with an optional cigarette lighter, plug the switch harness 6-pin connector into the cigarette lighter 6-pin connector.

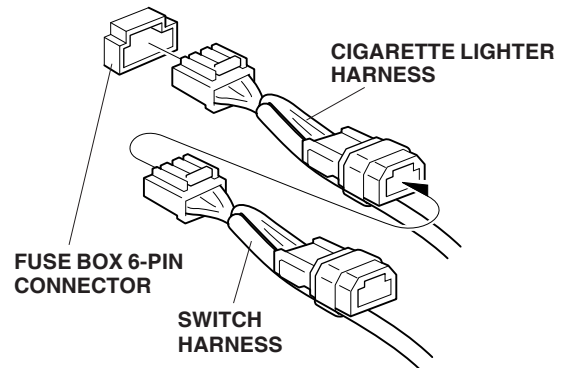

45. Reinstall the fuse box.
46. Locate the 1-pin connector blue-taped to the vehicle harness in front of the fuse box, and remove the blue tape to free the connector. Plug the remaining 1-pin connector of the switch harness into this 1-pin connector. Then, secure the 1-pin connector to the vehicle harness with one wire tie.

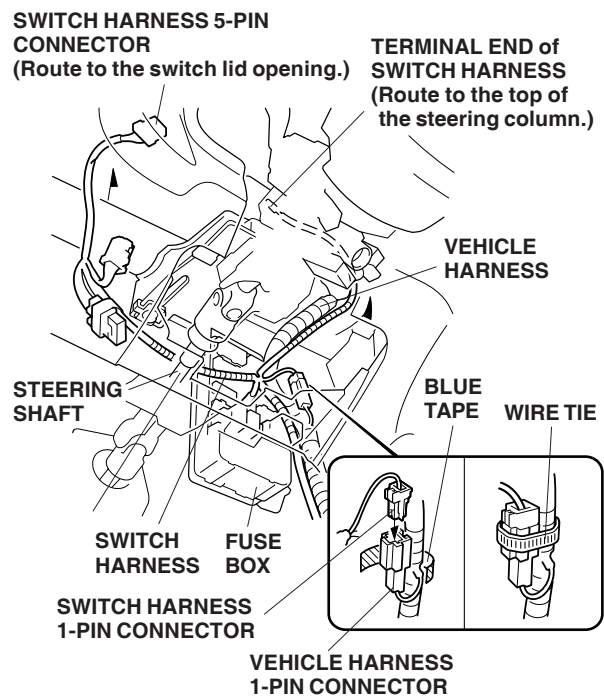

47. Route the 5-pin connector of the switch harness under the steering shaft to the switch opening in the instrument panel.
48. Route the terminal end of the switch harness to the top of the steering column along the vehicle harness.

- Above the steering column, disconnect the vehicle 16-pin connectors. Remove the retainer, and insert the switch harness terminal into the 16-pin connector at the location shown. Reinstall the retainer.

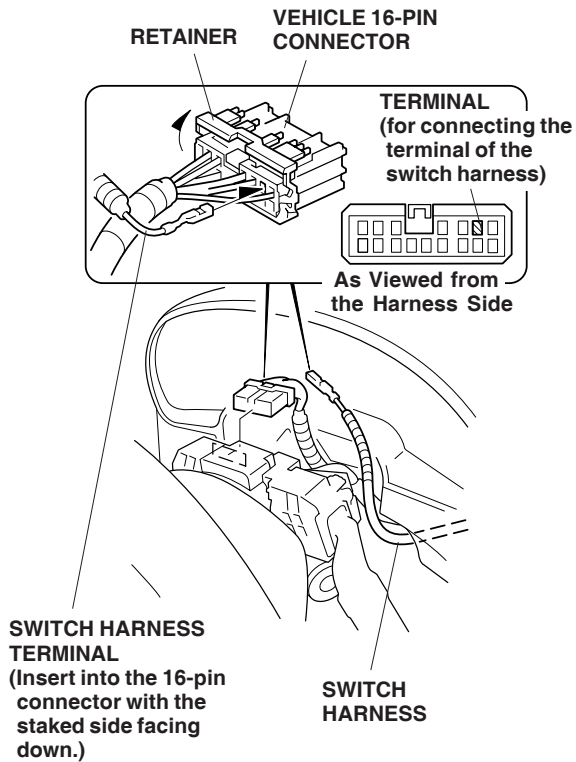

- Reconnect the vehicle 16-pin connector.

- Route the switch harness 12-pin connector to the center console opening alongside the vehicle harness.

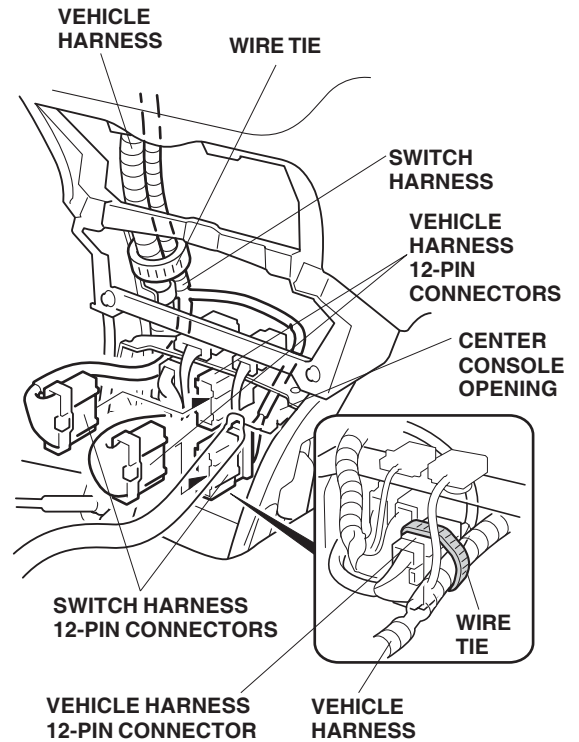

- At the center console opening, unplug the vehicle 12-pin connector.
- Connect the vehicle harness 12-pin connectors to the switch harness 12-pin connectors.
- Secure the switch harness to the vehicle harness with two wire ties in the areas shown.

- Attach the fuse label (20A) to the switch harness fuse case.

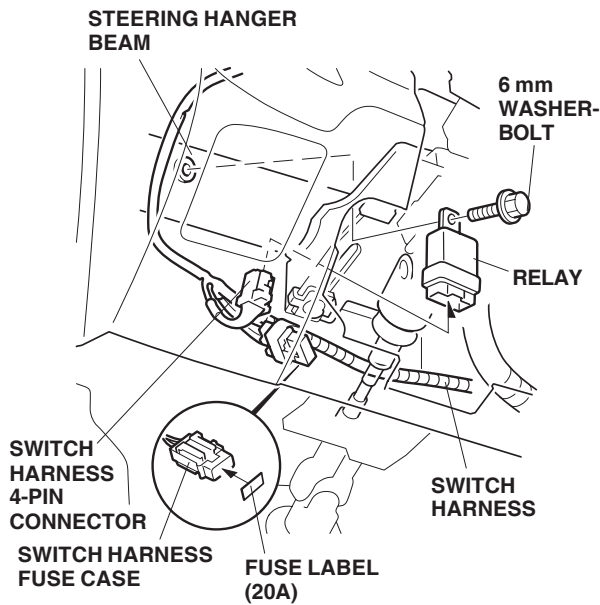

- Position the relay on the steering hanger beam, and install the 6 mm washer-bolt. Plug the switch harness 4-pin connector into the relay.
- Pull the switch harness 5-pin connector out through the instrument panel.

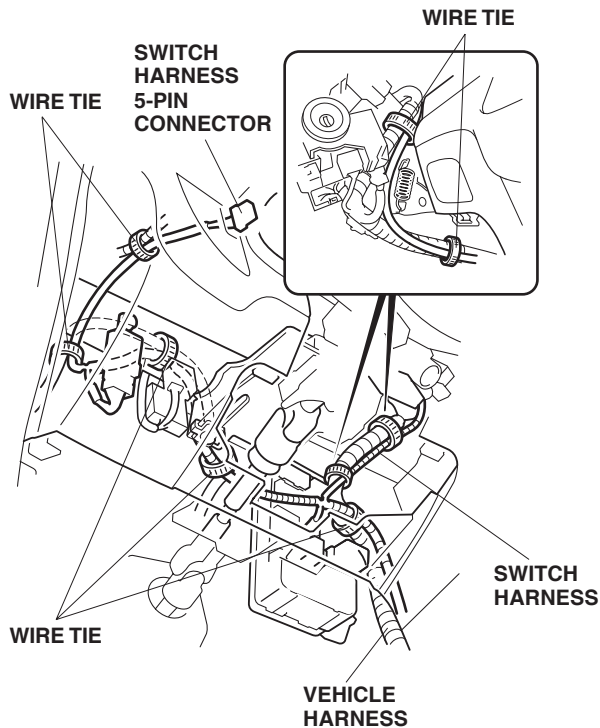

- Secure the switch harness to the vehicle harness with seven wire ties in the areas shown.

- Plug the switch harness 5-pin connector into the rear of the switch.

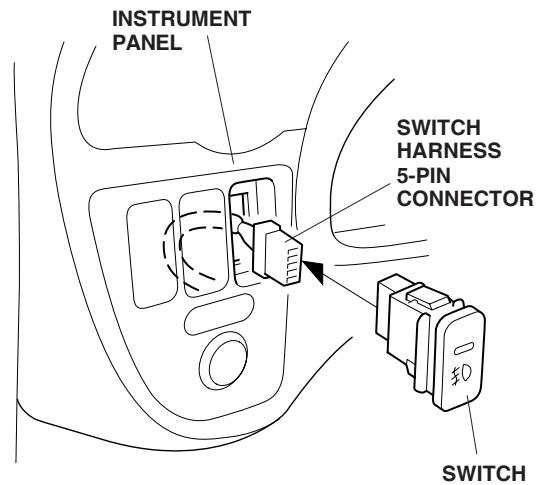

- Install the switch into the instrument panel.
 - Check that all wire harnesses are routed properly and all connectors are plugged in.
 - Reinstall all removed parts.
 - Reconnect the negative cable to the battery, and reset the radio station presets.
- NOTE:** Whenever the battery is disconnected, the driver's window AUTO function is disabled.
- Start the engine. Push down on the driver's window switch until the window is fully open.
 - Pull up on the driver's window switch to close the window completely, then hold the switch for two seconds.
 - Lower and raise the driver's window to check the window AUTO function.

USE AND CARE

How to Operate the Fog Lights

- Turn the light switch to the "D" position (headlights on low beam).
- Press the fog light switch (indicator is on).

NOTE: The fog light lenses can cloud when the outside temperature is cold; this is normal and should go away in warm weather.

Fog Light Aiming Adjustment

1. Adjust the fog lights:
 - Adjust the aiming according to local laws and regulations.
 - To adjust, turn the aiming adjustment screw clockwise or counterclockwise until the correct aiming is obtained.

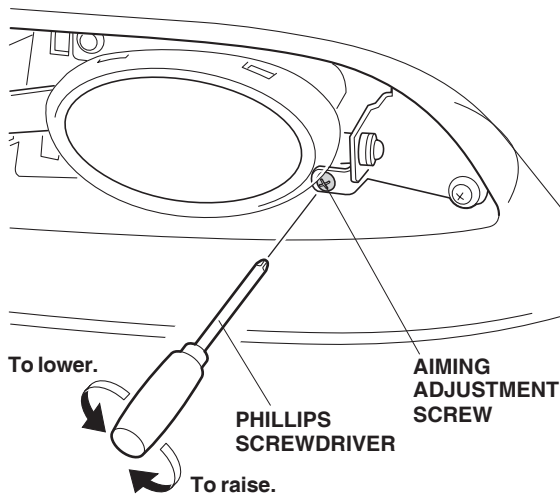

Bulb Replacement

1. Loosen the screw, and remove the left trim (one tab).

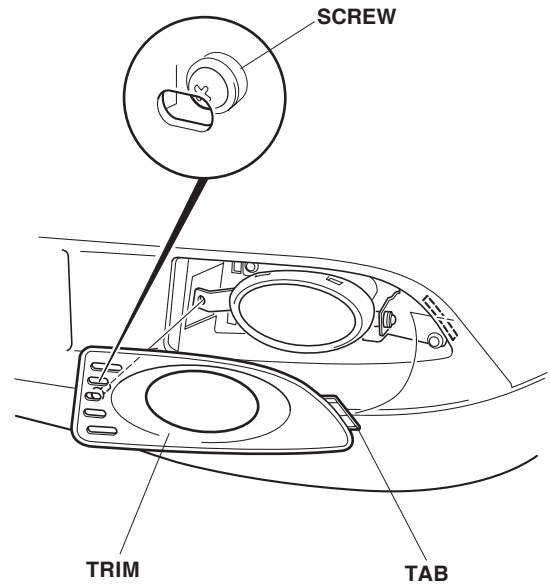

2. Remove the three washer-screws and one washer bolt, and pull the fog light toward you. Unplug the connector, and remove the fog light.

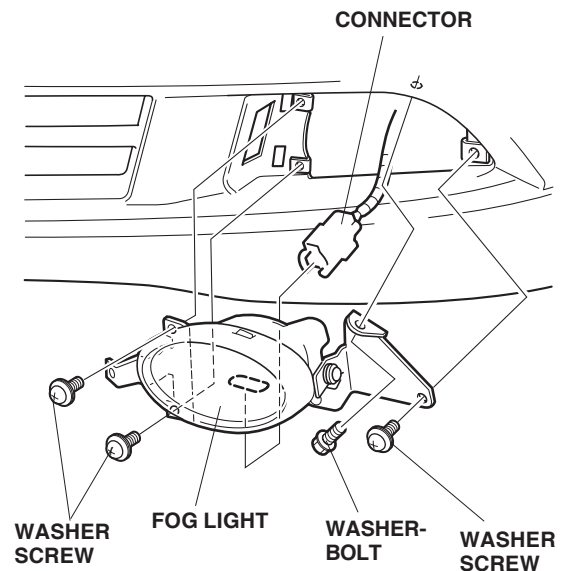

3. Remove the bulb from the fog light by turning it counterclockwise and pulling it toward you.

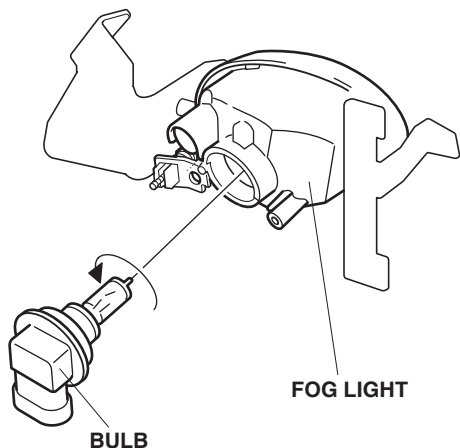

4. Install the new bulb into the fog light:
 - Use only a Honda halogen light bulb of specified wattage.
Rating: 12V 55W H11 Halogen Light Bulb
 - Do not touch the bulb. Oily or greasy substances on the bulb could shorten its service life due to the heat produced when the bulb is turned on. If the bulb is accidentally touched, wipe it clean with a clean, soft cloth that has been dampened with denatured alcohol or a mild detergent solution.

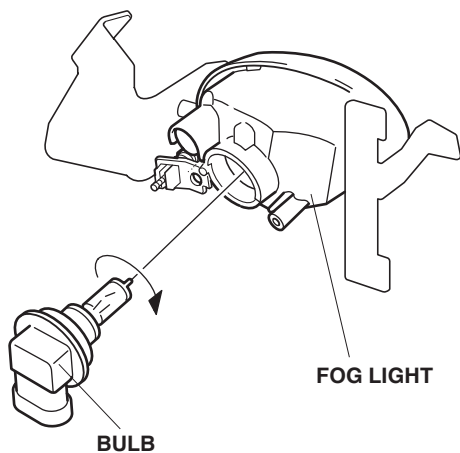

5. Reinstall the fog light in the reverse order of removal:
 - Check that the wire harnesses are not pinched.
 - Make sure you tighten the self-tapping screws securely.

CIRCUIT DIAGRAM

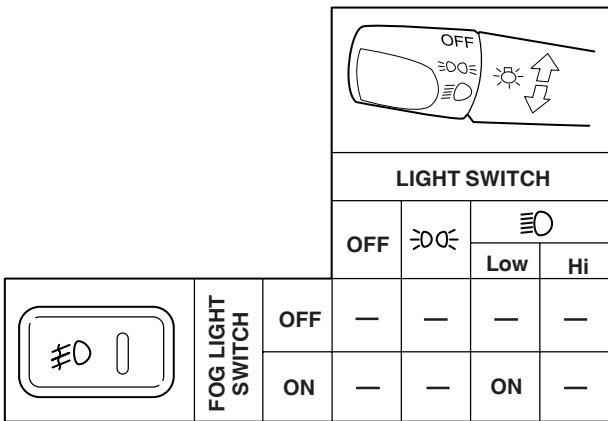
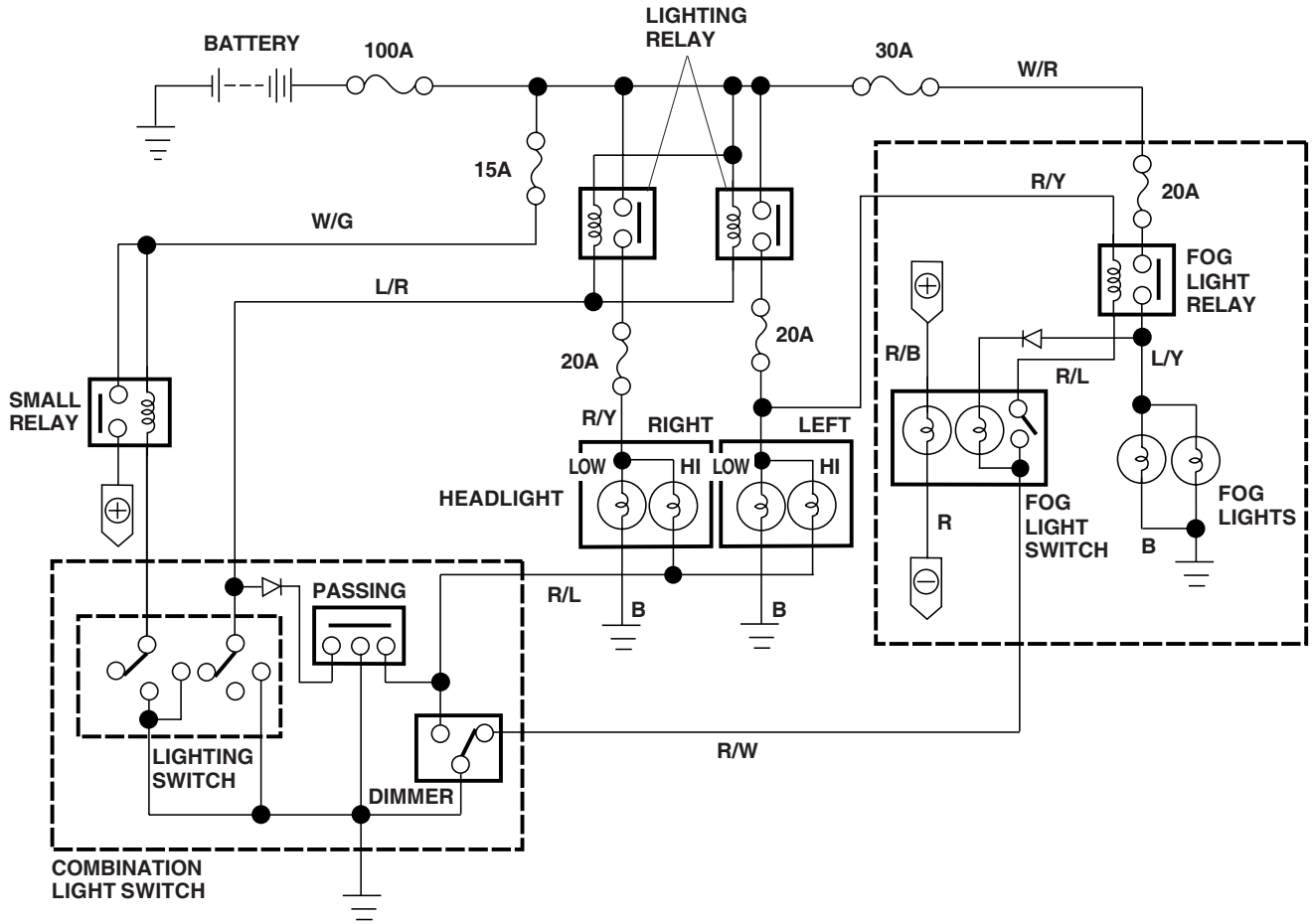

B	BLACK	BR	BROWN
Y	YELLOW	O	ORANGE
L	BLUE	SB	SKY BLUE
G	GREEN	LG	LIGHT GREEN
R	RED	P	PINK
W	WHITE	GR	GRAY