



INSTALLATION INSTRUCTIONS

Accessory
ALL SEASON FLOOR MATS

Application
TSX

Publications No.
B11 41531
MAY 2009

PARTS LIST

Driver's all season floor mat



Front passenger's all season floor mat

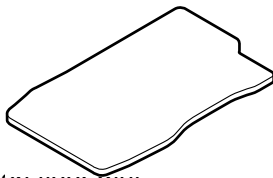

Left rear all season floor mat

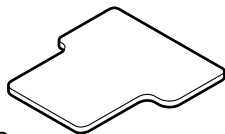

Right rear all season floor mat

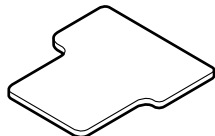
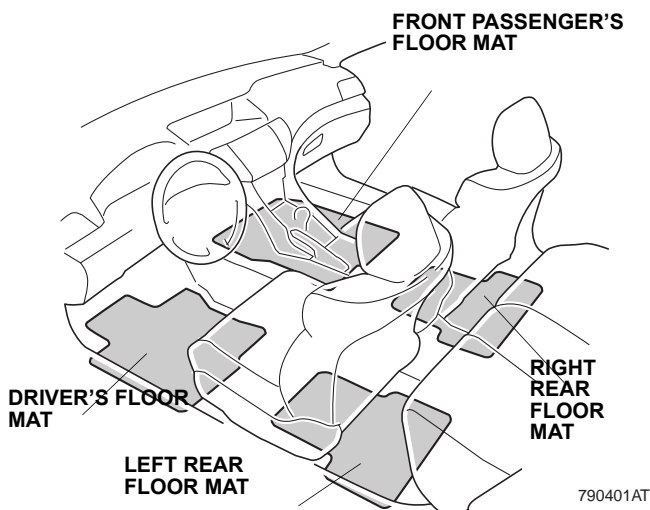

Illustration of the Floor Mats installed in the Vehicle



790401AT

INSTALLATION

NOTE:

- Before installing the floor mats, identify their installation positions.
 - Holders are required for the driver's floor mat; the holders prevent the front floor mat from sliding forward and possibly interfering with the pedals.
 - If you remove the driver's floor mat, make sure you reanchor it when you put it back in the vehicle.
 - If you replace the floor mat, use factory mats designed to be used with the holders.
 - If you use a non-factory floor mat in the driver's footwell, make sure it fits properly and that it can be used with the holders.
 - Do not put additional floor mats on top of the anchored mat, otherwise the additional floor mats may slide forward and possibly interfere with the pedals.
 - Identify each floor mat by the marks on the back of each mat: the mats marked "R" or "Passenger's side" go on the right side of the vehicle; the mats marked "L" or "Driver's side" go on the left side.
1. Position the driver's floor mat by aligning the tabs with their respective holders.

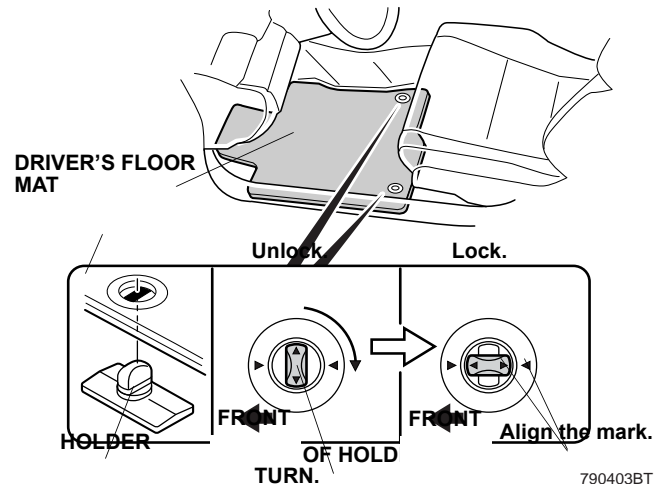

790403BT

2. Turn the tabs of the holders one quarter turn to secure the floor mat.

3. Position the front passenger's floor mat in the front passenger's footwell.

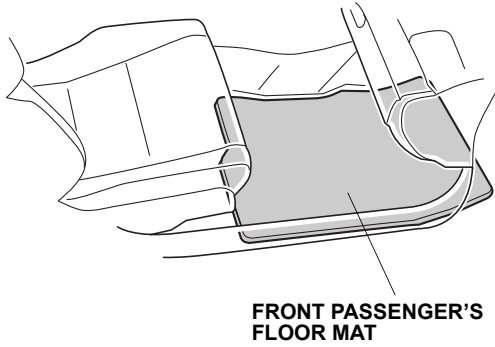

4. Position the right rear and left rear floor mats in the right rear and left rear passenger's footwells.

