



INSTALLATION INSTRUCTIONS

Accessory
SHIFT KNOB

Application
2010 MDX

Publications No.
BII 42098
Issue Date
JAN 2010

PARTS LIST

Shift knob



2 Screws



TOOLS AND SUPPLIES REQUIRED

Stubby Phillips screwdriver

Pliers

Torque screwdriver (T/N CDI 401 SM)
(Available through the American Honda Tool and Equipment Program; call (888) 424-6857)

Shop towel

Plastic Trim Tool (T/N SILTRIMTL10)

Tape measure

INSTALLATION

1. With the parking brake on, remove the shift lock release lid with a plastic trim tool. Insert the vehicle's ignition key into the opening, and move the shift lever knob to the "MD" range.

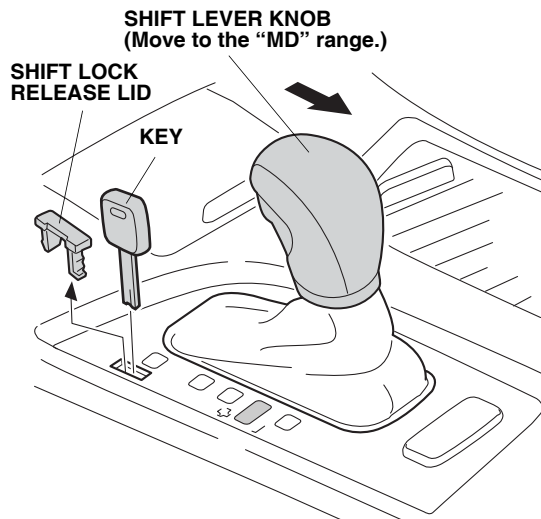

2. Using pliers, place a shop towel between the shift boot and pliers, and squeeze in on the two retaining tabs at the position shown. Lower the shift knob boot.

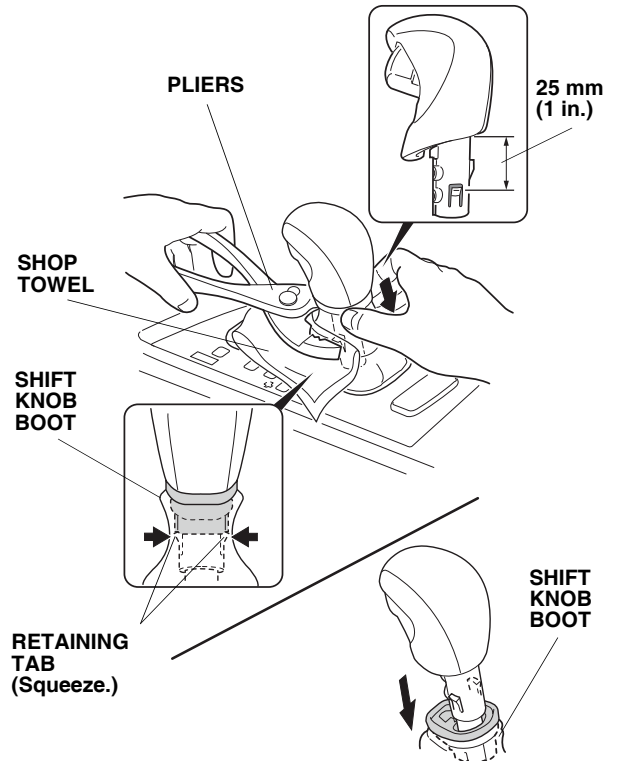

3. Remove the two screws from the shift knob, and remove the shift knob by pulling it up.

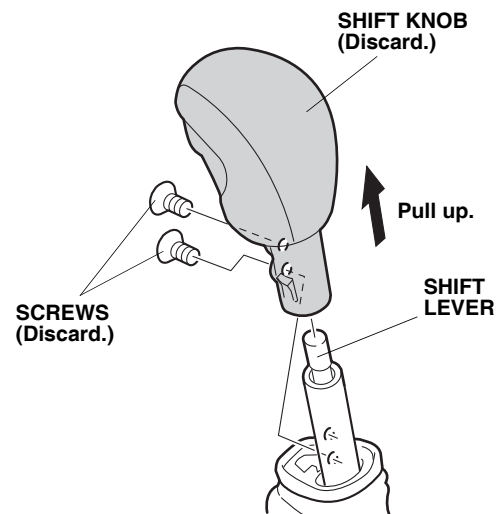

4. Install the new shift knob using the two new screws. Using a torque screwdriver, torque the screws to 3 N·m (18 lb-in). Do not overtighten the screws.

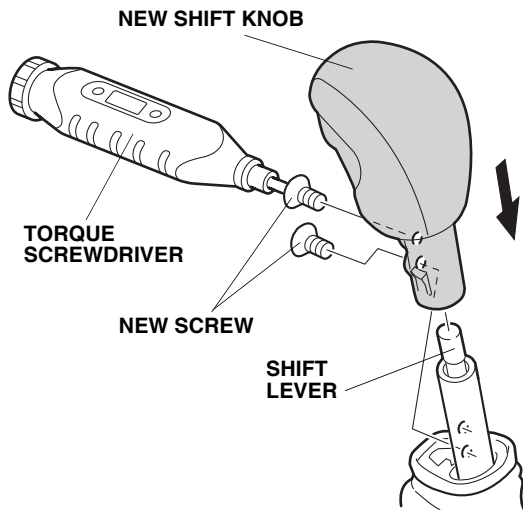

5. Pull the shift knob boot up into the normal position.

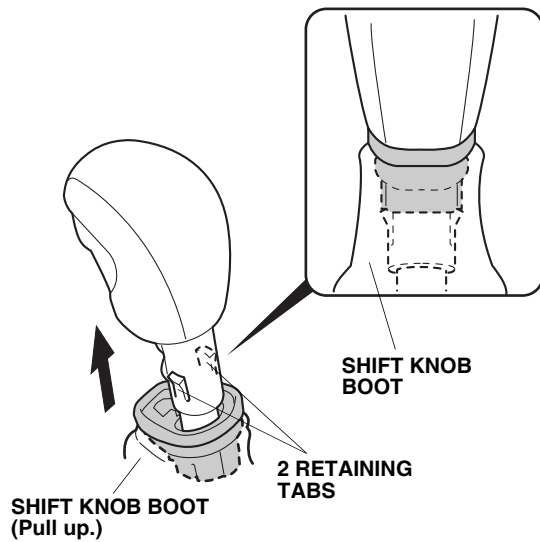

6. Reinstall the shift lock release lid.

USE AND CARE

- Use a sponge or cloth and a solution of mild liquid dishwashing soap and water to clean the shift knob.
- Rinse the knob completely with water, then dry it with a shop towel.
- Never use solvents such as benzene, thinner, or gasoline to clean the shift knob.