

H HONDA INSTALLATION INSTRUCTIONS	Accessory	Application	Publications No.
	CD PLAYER P/N 08A06-381-210	2000 ACCORD 2- AND 4-DOOR (EXCEPT EX)	All 20501
			Issue Date
			JULY 1999

PARTS LIST

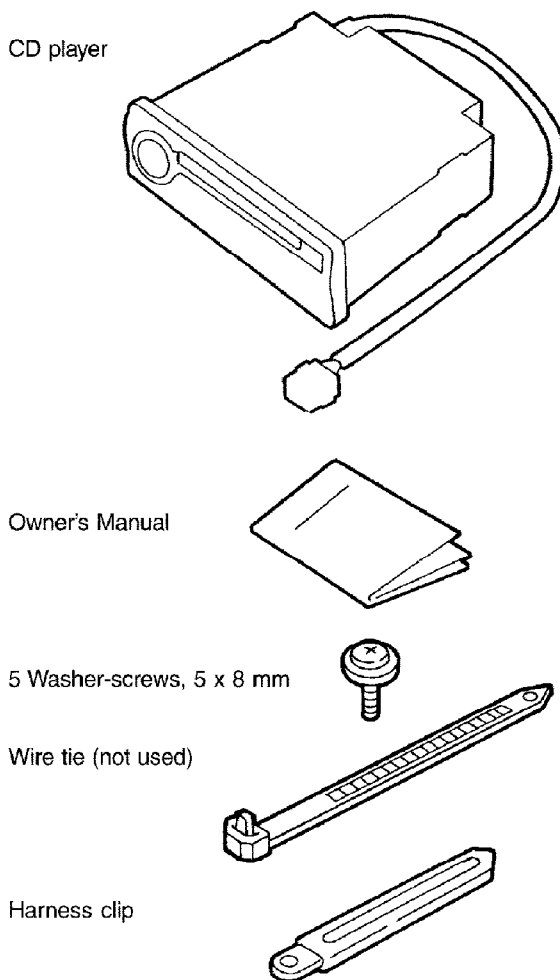

TOOLS AND SUPPLIES REQUIRED

#2 Phillips screwdriver
Shop towel
Masking tape
Flat-tip screwdriver

INSTALLATION

Customer Information: The information in this Installation Instruction is intended for use only by skilled technicians who have the proper tools, equipment, and training to correctly and safely add equipment to your car. These procedures should not be attempted by "do-it-yourselfers."

1. Write down the frequencies for the preset buttons.
2. Disconnect the negative cable from the battery.

If the vehicle you are working on is equipped with an optional ashtray with cigarette lighter, continue with step 3; if not, go to step 4.

3. Remove the ashtray with cigarette lighter (two self-tapping screws, one connector and four retaining clips).

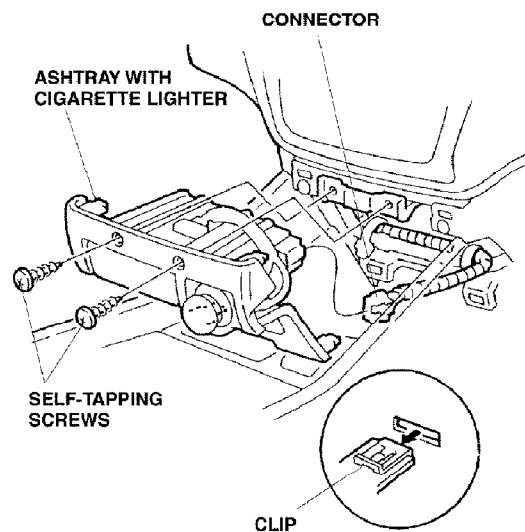

- Attach a piece of masking tape onto the console panel below the clock.

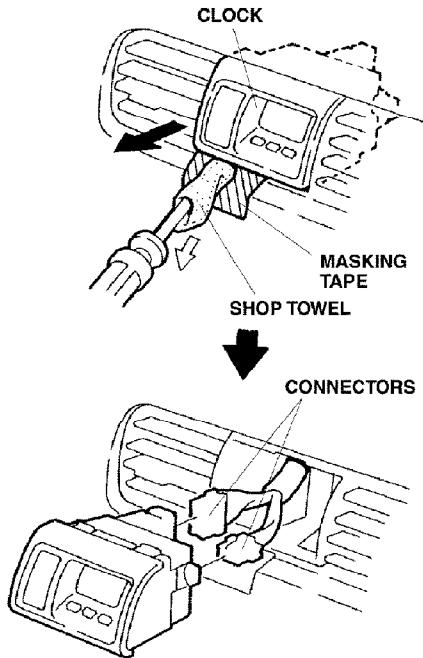

- Using a flat-tip screwdriver wrapped with a shop towel, gently pry up on the clock to release the clips; then disconnect the connectors and remove the clock.
- Remove the console panel (three self-tapping screws, five retaining clips, two retaining tabs, and two connectors).

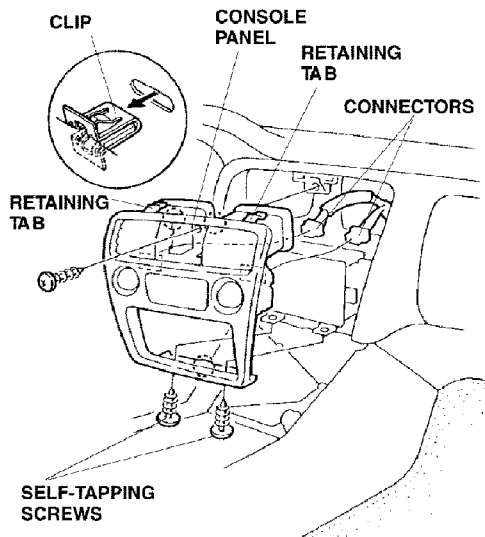

- Remove the radio/pocket assembly (four radio mounting bolts, and unplug the radio connector and the antenna lead).

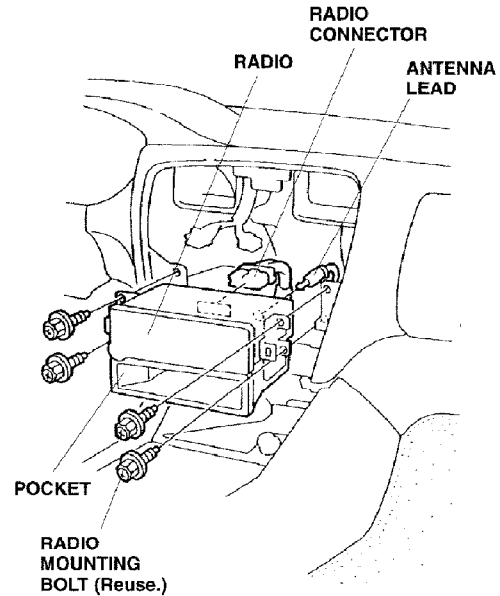

- Remove the left and right radio brackets from the radio/pocket assembly (four bolts and two self-tapping screws). Discard the pocket and the two self-tapping screws.

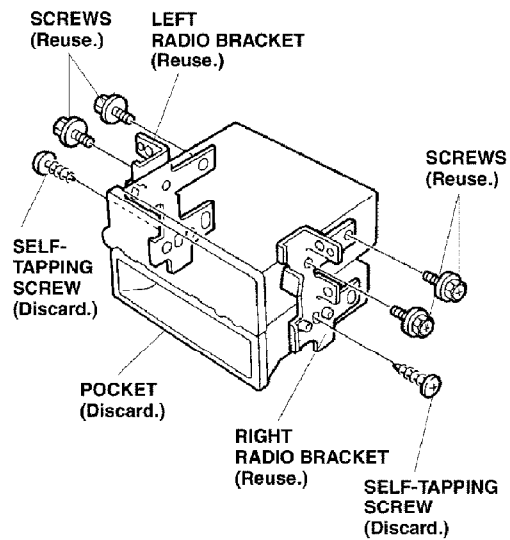

9. Attach the harness clip to the back of the radio with one 5 x 8 mm washer-screw.

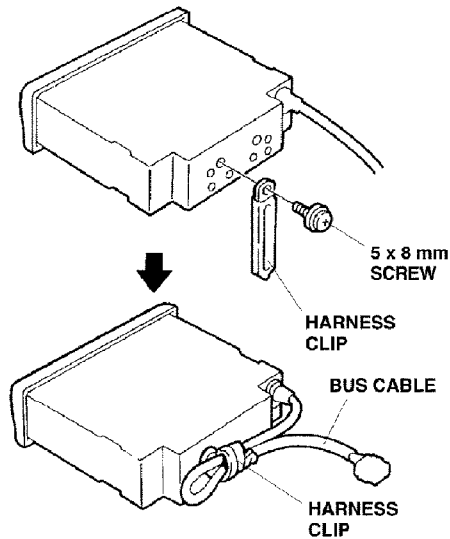

10. Fold the bus cable in half, and secure it with the harness clip.
11. Position the radio on the CD player, then assemble the CD player and radio with the brackets and four screws removed in step 8, and the four 5 x 8 mm washer-screws provided. Plug the bus cable connector into the back of the radio.

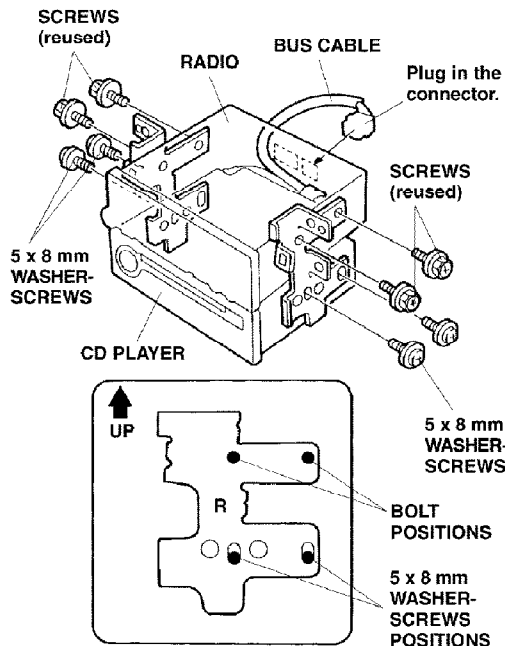

12. Install the radio/CD player with the four radio mounting bolts removed in step 7.

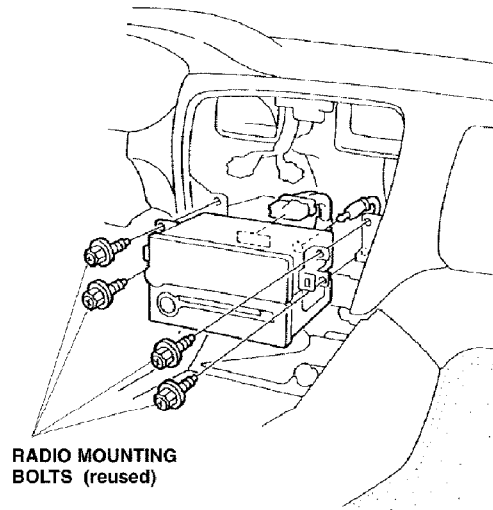

13. Reinstall all removed parts.
14. Check that all wire harnesses are routed properly and all connectors are plugged in.
15. Reconnect the negative cable to the battery.
16. Reset the radio station presets and the clock.
17. Check that the radio and the CD player