



INSTALLATION INSTRUCTIONS

Accessory BASS SPEAKER SYSTEM ATTACHMENT	Application CIVIC 2-DOOR (DX, LX)	Publications No. All 30856
		Issue Date SEP 2005

PARTS LIST

**Bass Speaker System Attachment Kit (sold separately) :
P/N 08B54-SVA-100**

Bass speaker system wire harness

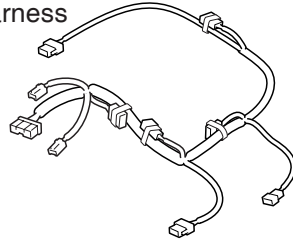

Right bracket

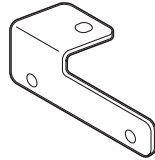

Left bracket

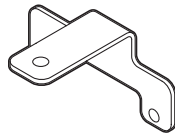

2 Washer-bolts, 6 x 16 mm



2 Clip nuts



10 Wire ties

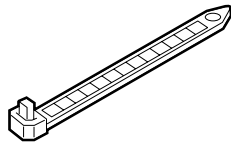

3 EPT sealers

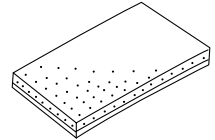

Fuse seal

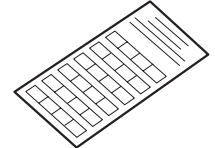

Oval cushion

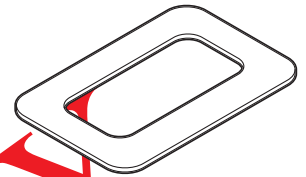

User's Information

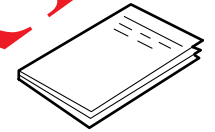

**Bass Speaker System Kit (sold separately) :
P/N 08A54-SNA-100**

2 Bass speakers

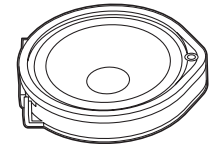

Bass unit

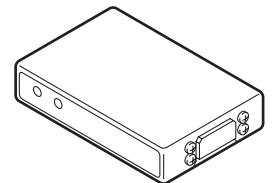

PRELIMINARY

TOOLS REQUIRED

Phillips screwdriver
Flat-tip screwdriver
10 mm and 8 mm wrenches
Shop towel
Isopropyl alcohol
Clip removal tool

Illustration of the Bass Speaker System Installed on the Vehicle

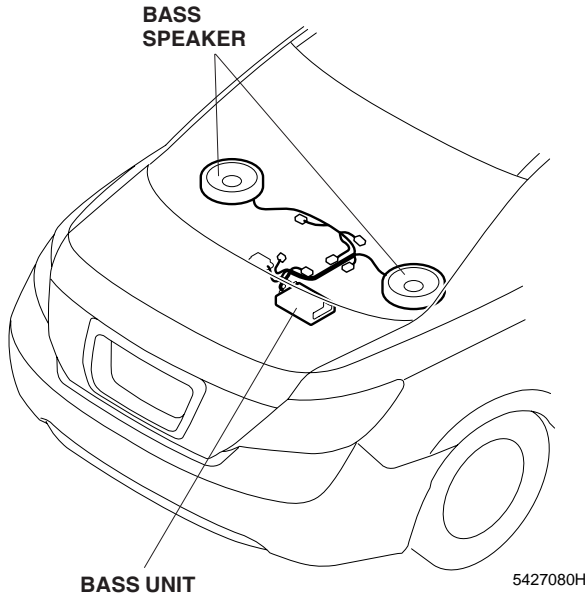

INSTALLATION

Customer information: The information in this installation instruction is intended for use only by skilled technicians who have the proper tools, equipment, and training to correctly and safely add equipment to your vehicle. These procedures should not be attempted by "do-it-yourselfers".

1. Make sure you have the anti-theft code for the radio, then write down the frequencies for the preset buttons.
2. Disconnect the negative cable from the battery.

3. Open the trunk lid. Pull the release handle on the bottom of the parcel shelf to tilt the rear seat to the front.

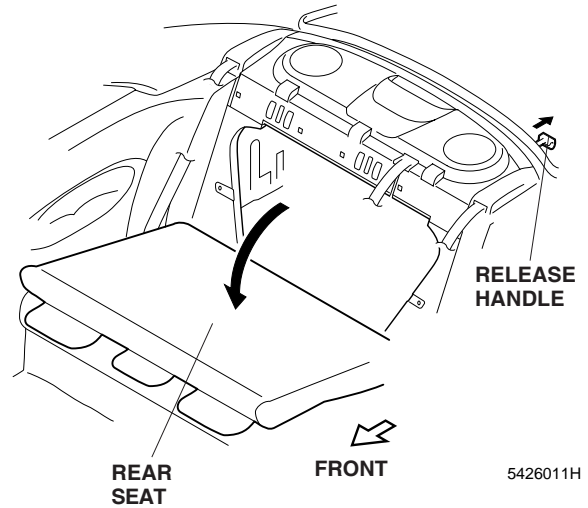

4. Remove the trunk spring protector (4 clips).

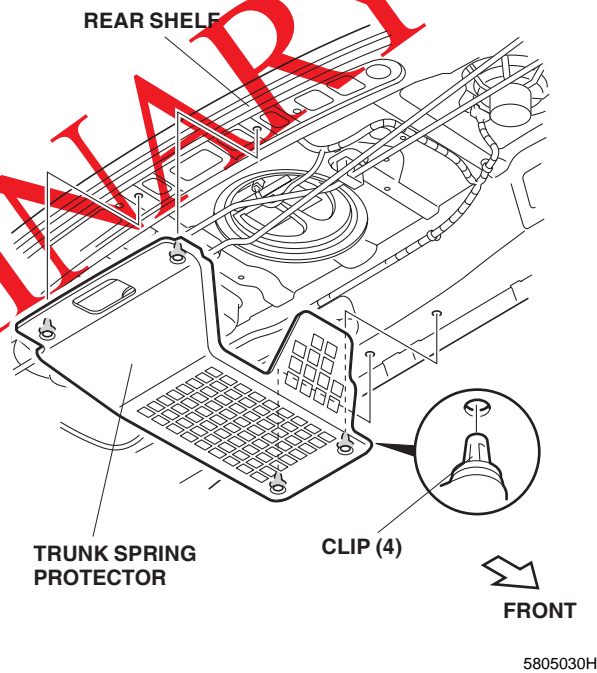

- In the trunk, unplug the vehicle 2-pin connector from the high-mount stop light.

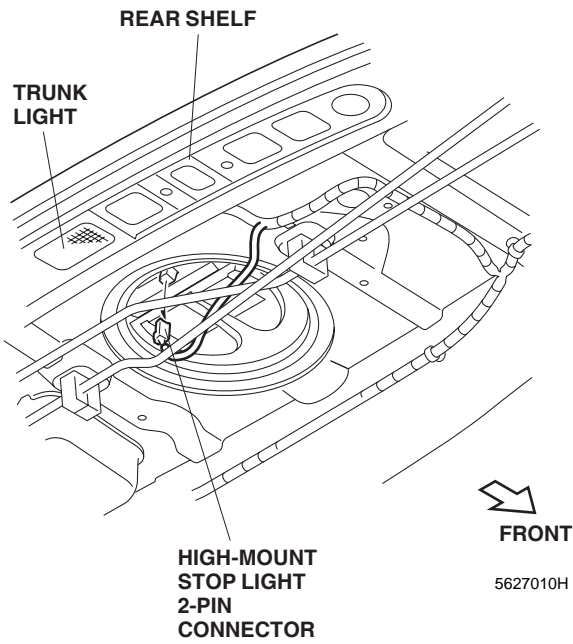

- Remove the rear speaker tray (10 clips, 4 tabs) while lightly pulling up on the end of the rear speaker tray as shown.
 - Attach clips left on the vehicle panel onto the rear speaker tray.

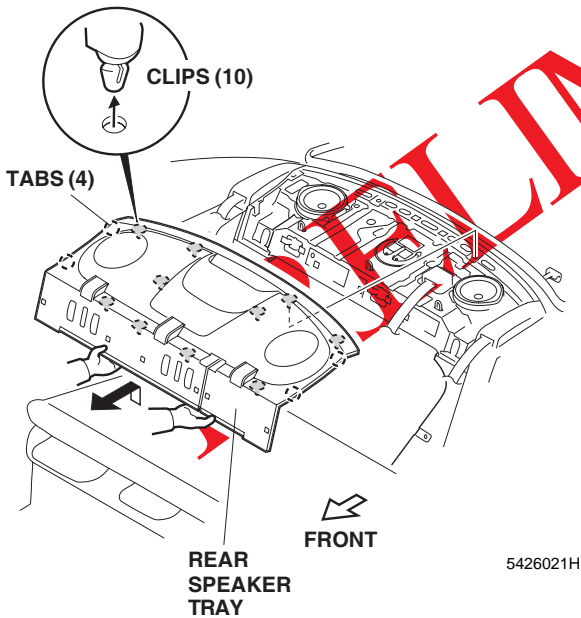

Installing the Bass Speakers

- Remove the right and left speakers (one screw for each speaker).

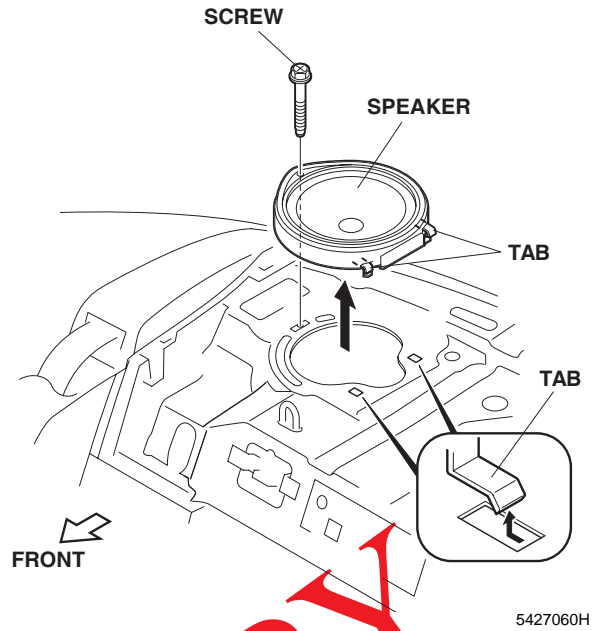

- Install the right and left speakers using the screws removed in step 7.

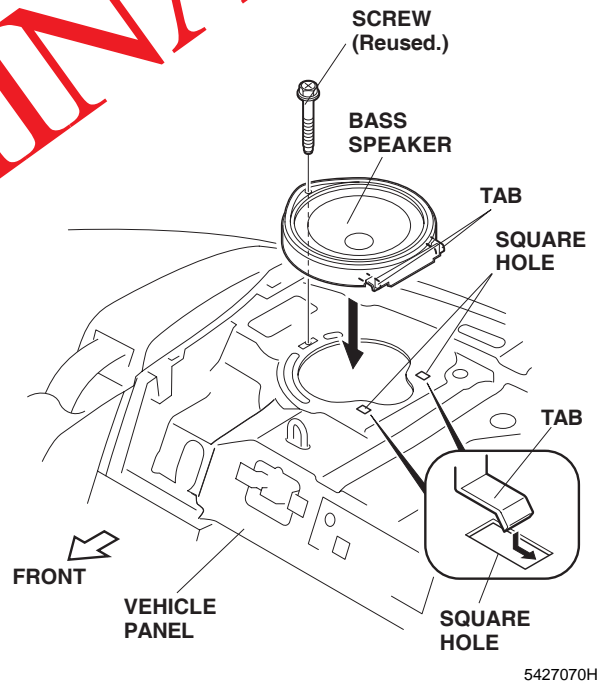

Installing the Bass Unit

- Clean the back of the bass unit with isopropyl alcohol on a shop towel. Be sure to clean the outer edge on the back of the bass unit as well.

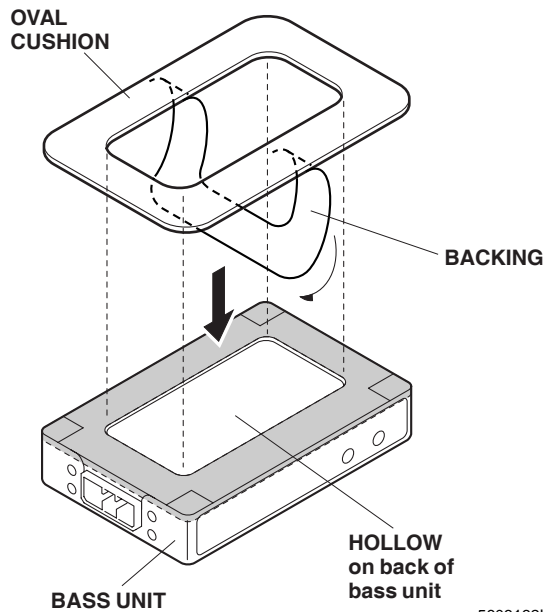

5603132H

- Align the inner circle of the oval cushion with the hollow edge on the back of the bass unit, then attach the oval cushion to the bass unit.
- Fold the excess oval cushion down around the bass unit.

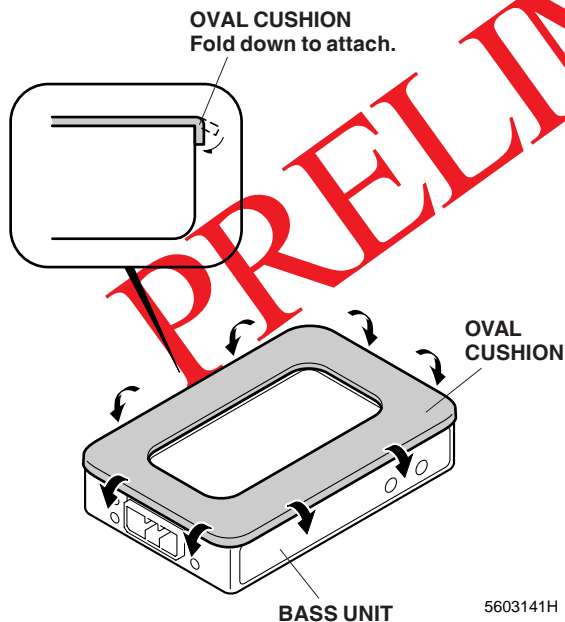

5603141H

- Remove the four upper screws from the bass unit, and secure the right and left side brackets to the bass unit with the four screws.

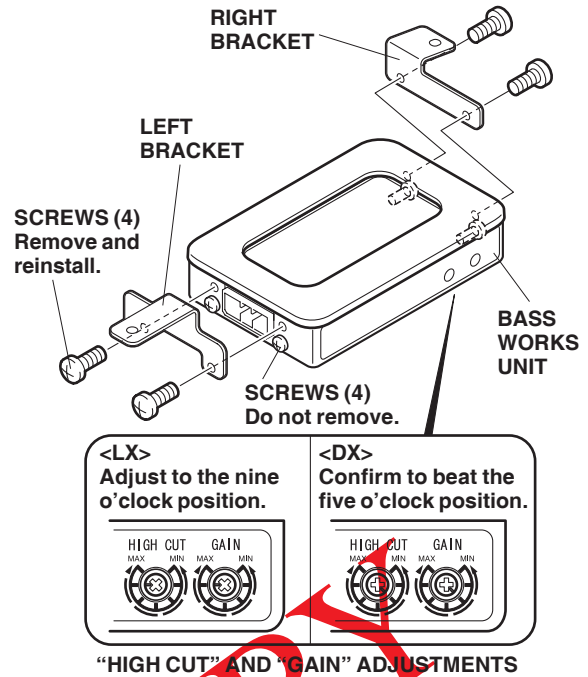

5419013H

- <DX> Confirm that the HIGH CUT and GAIN adjustments on the bass unit point at the five o'clock position.

<LX> Adjust the HIGH CUT and GAIN adjustments on the bass unit to the nine o'clock position.

 - The adjustment settings are predicated on the audio/navigation unit as the factory-set. (See step 33 and the User's Information.)

- Slide the two spring nuts into the square holes in the rear shelf.

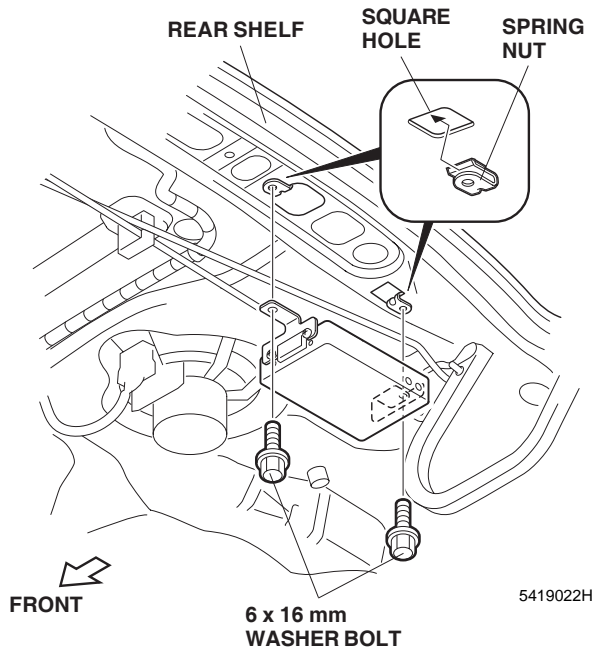

- Mount the bass unit to the rear shelf with two 6 x 16 mm washer-bolts.

Routing the Bass Speaker System Wire Harness

- Reinstall the rear speaker tray removed in step 6.

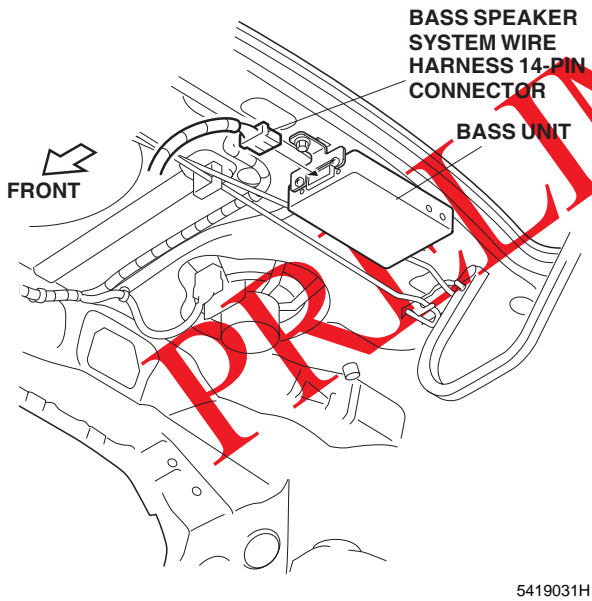

- Plug the bass speaker system wire harness 14-pin connector into the bass unit.

- Using a flat-tip screwdriver wrapped with shop towel, remove the trunk light (two tabs).

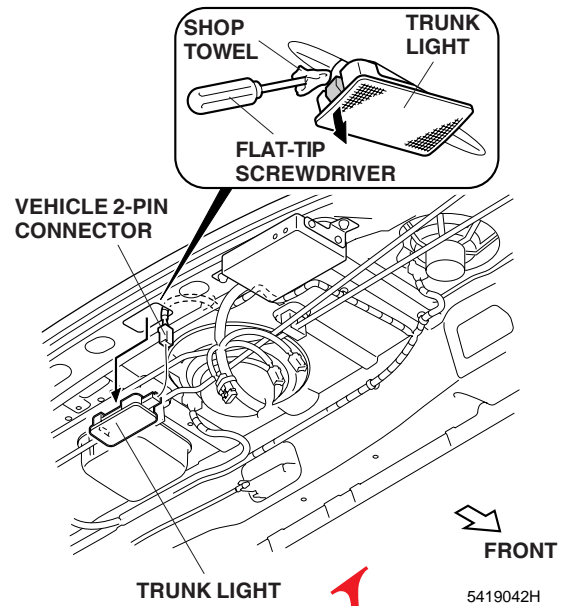

- Unplug the vehicle 2-pin connector from the trunk light.
- Route the bass speaker system wire harness over the trunk springs.

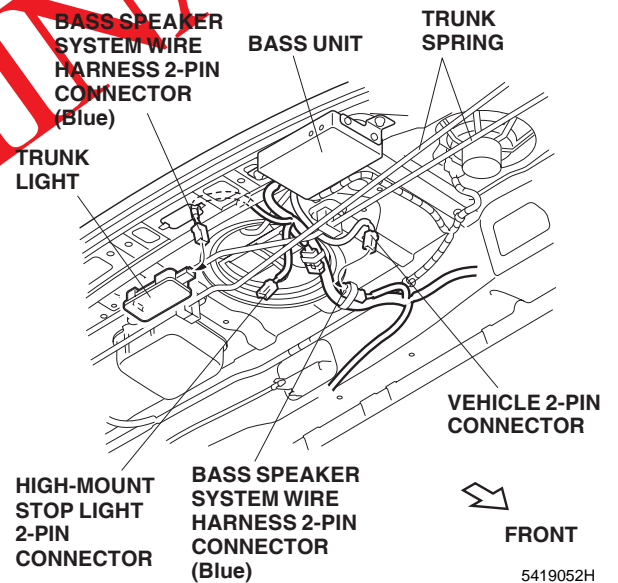

- Plug the bass speaker system wire harness 2-pin connector (blue) into the trunk light, then connect the vehicle 2-pin connector into the bass speaker system wire harness 2-pin connector (blue) taped to the harness.

22. Plug the bass speaker system wire harness 2-pin connector into the high-mount stop light.

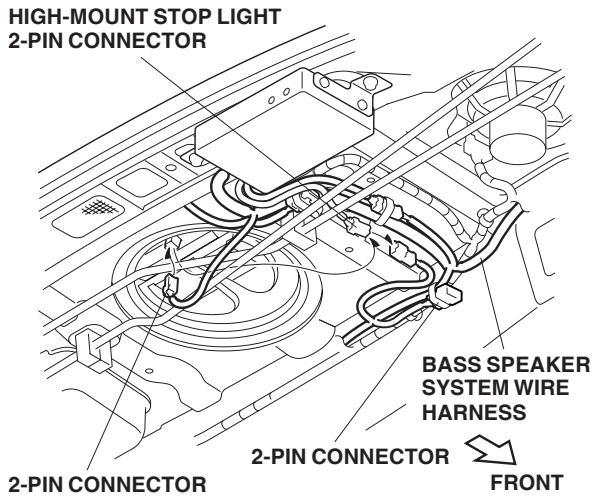

5426031H

23. Route the high-mount stop light 2-pin connector over the trunk spring, then plug it into the 2-pin connector taped to the bass speaker system wire harness.

24. Attach the fuse label "5A OPTION FUSE" to the fuse case taped to the bass speaker system wire harness.

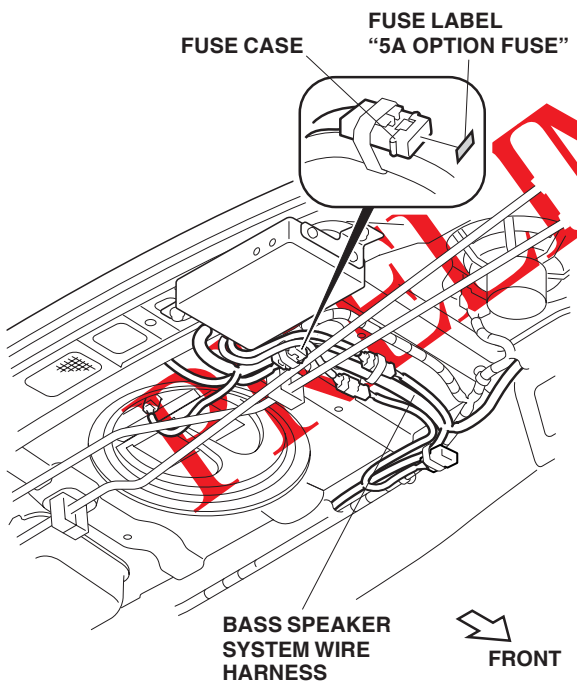

5419062H

25. Unplug the vehicle 2-pin connector from the vehicle right and left speakers, then plug them into the 2-pin connectors taped on the long branch of the bass speaker system wire harness.

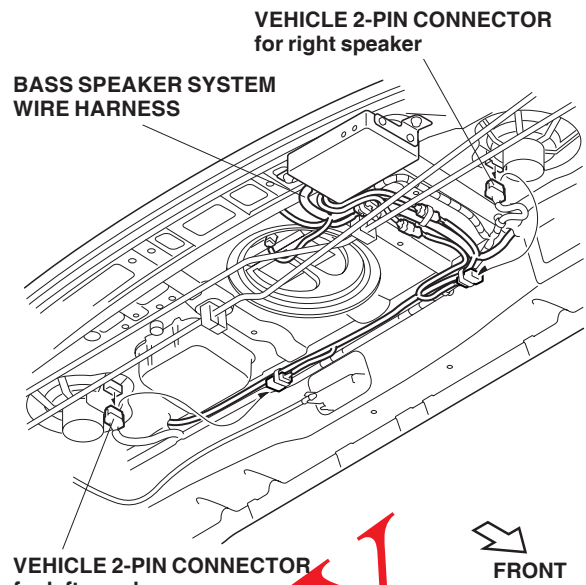

5419072H

26. Plug the bass speaker system wire harness 2-pin connectors into the right and left bass speakers.

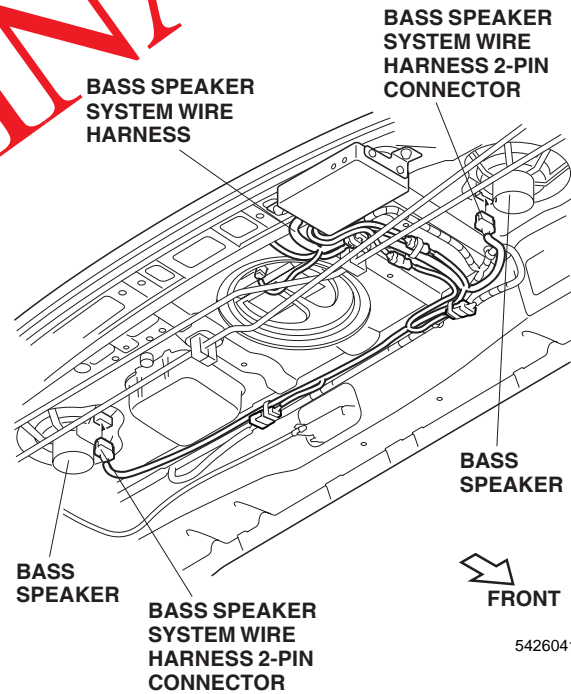

5426041H

Secure the Bass Speaker System Wire Harness

27. Wrap one EPT sealer around the three connector joints in the areas shown, then secure them with three wire ties.

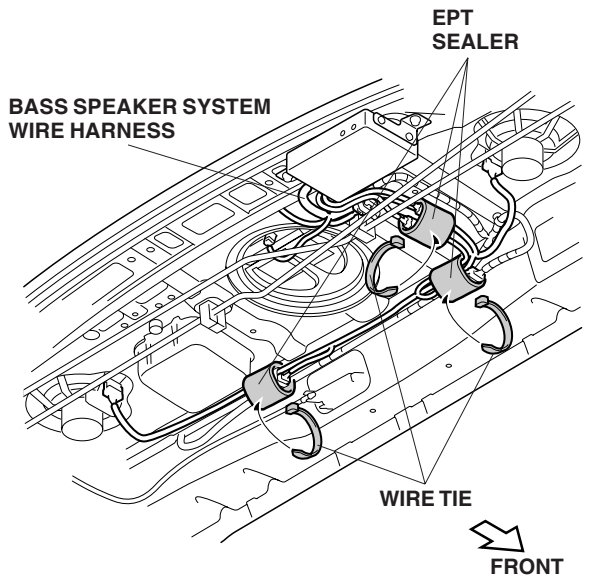

5427011H

28. Using seven wire ties, secure the bass speaker system wire harness to the vehicle harness in the areas shown.

- Make sure that the bass speaker system wire harness does not interfere with the trunk springs during the closing and opening of the trunk lid.

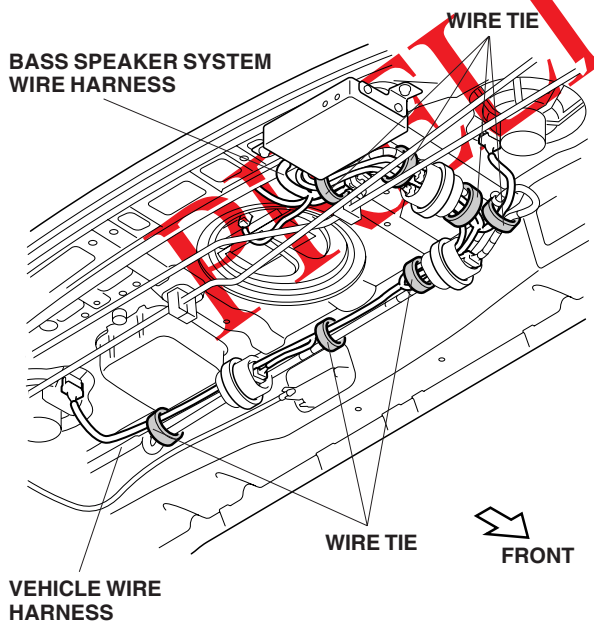

5427021H

29. Check that all wire harnesses are routed properly and all connectors are plugged in.
30. Reconnect the negative cable to the battery.
31. Reinstall all removed parts.
32. Enter the customer's radio anti-theft code, and reset the radio station presets.
33. Be sure to set all the volume control adjustments on the vehicle audio/navigation unit, such as BASS, TREBLE, FAD, BALANCE and so on, as the factory-set.

NOTE: When the battery is disconnected, the driver's window AUTO function is disabled.

- Start the engine. Push down on the driver's window switch until the window is fully open.
- Pull up on the driver's window switch to close the window completely, then hold the switch for 2 seconds or more.
- Lower and raise the driver's window to check operation of the driver's window AUTO function.