



# INSTALLATION INSTRUCTIONS

Accessory  
**SIDE STEP**  
P/N 08L33-SCV-100A

Application  
**2010 ELEMENT**

Publications No.  
**All 42712**

Issue Date  
**SEP 2009**

## PARTS LIST

Left side step

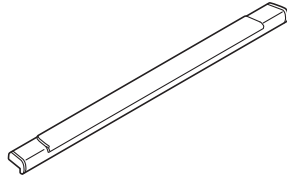

Right side step

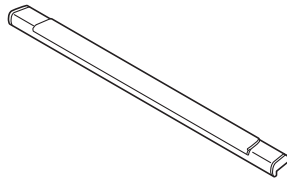

2 Brackets A

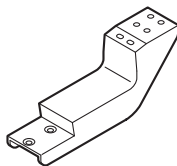

2 Bracket C

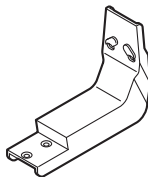

2 Brackets D

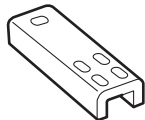

22 Flange bolts

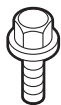

4 Plate bolts

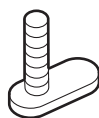

8 Small flange nuts



4 Large flange nuts



4 Plastic washers



## TOOLS AND SUPPLIES REQUIRED

Ratchet

13 mm and 18 mm Combination wrenches

13 mm and 18 mm Sockets

Torque wrench

## INSTALLATION

**Customer Information:** The information in this installation instruction is intended for use only by skilled technicians who have the proper tools, equipment, and training to correctly and safely add equipment to your vehicle. These procedures should not be attempted by "do-it-yourselfers."

NOTE: Be careful not to damage the body paint finish.

1. Position the bracket D on the bracket A, and install four flange bolts with four small flange nuts. Do not tighten the flange bolts and small flange nuts yet.

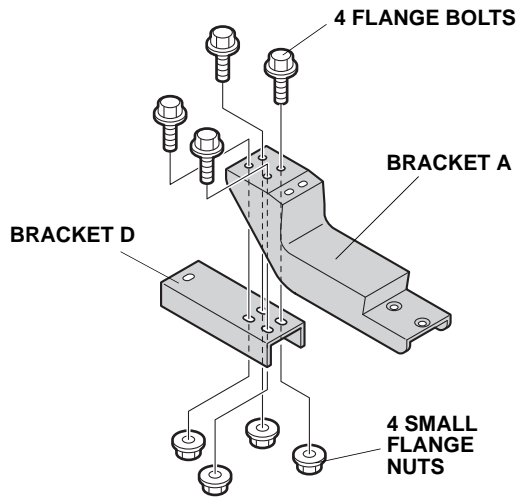

2. Position the bracket A and the bracket D on the vehicle, and install three flange bolts. Do not tighten the flange bolts yet.

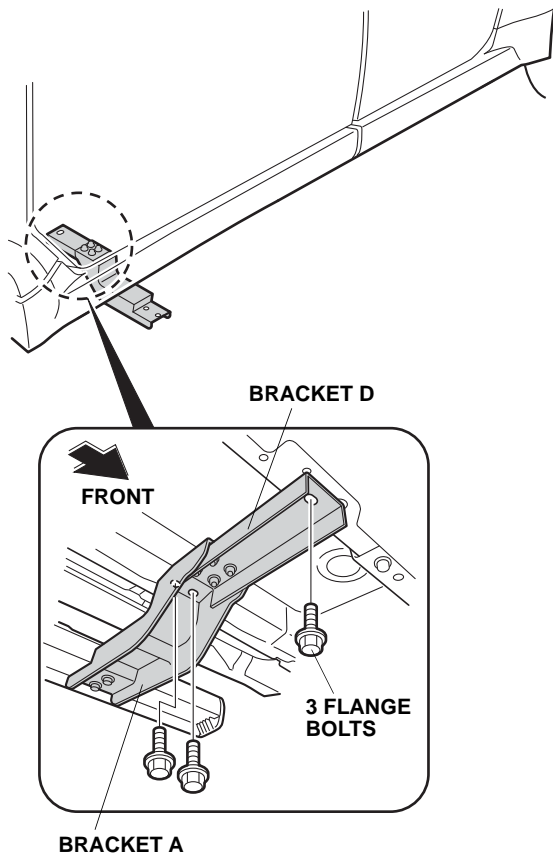

3. Install one plastic washer halfway onto each plate bolt.

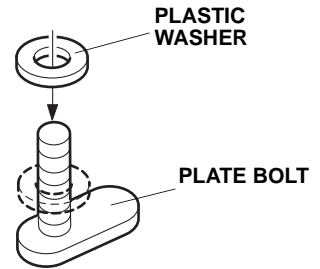

4. Insert the head of the plate bolt into the frame hole as shown. Hold the bolt by the threads and rotate it into position, then push the plastic washer against the frame. Install the other plate bolt the same way.

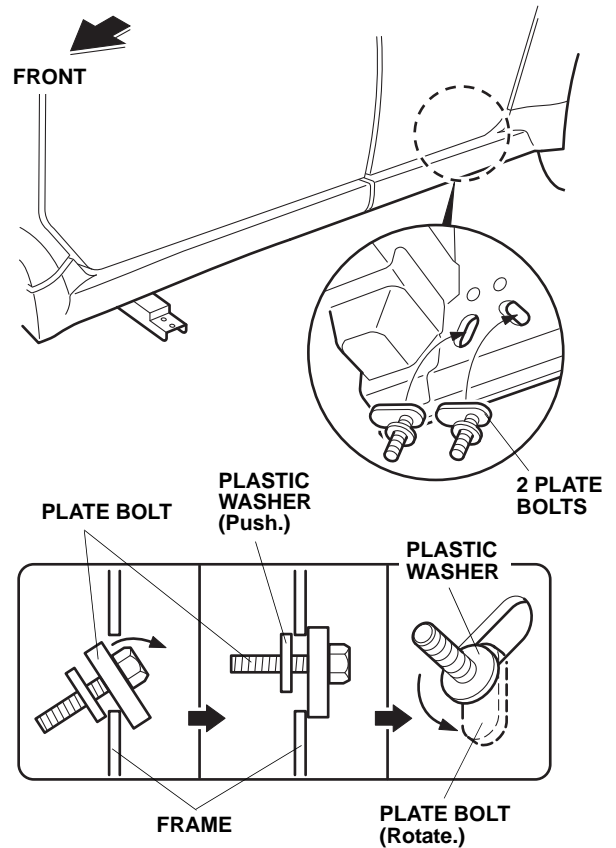

5. Position the bracket C on the vehicle, and install two large flange nuts.

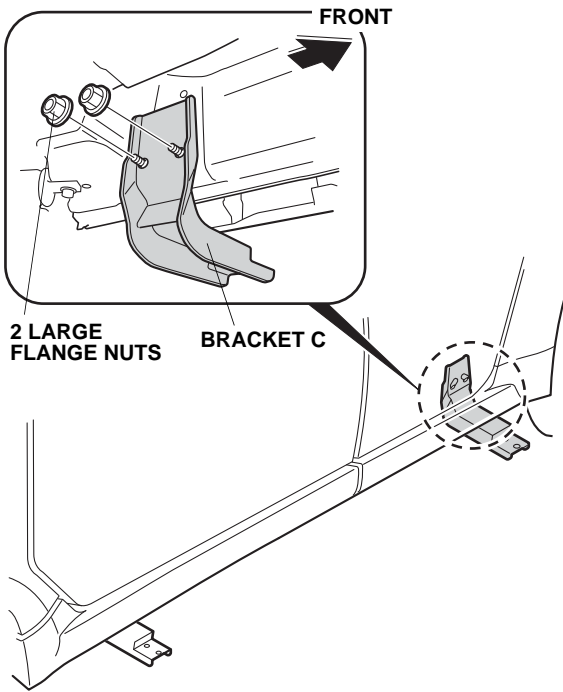

6. Torque the two large flange nuts to 20.6 N·m (15.2 lbf-ft).

7. Position the bracket A and bracket C on the left side step, and install four flange bolts. Do not tighten the flange bolts yet.

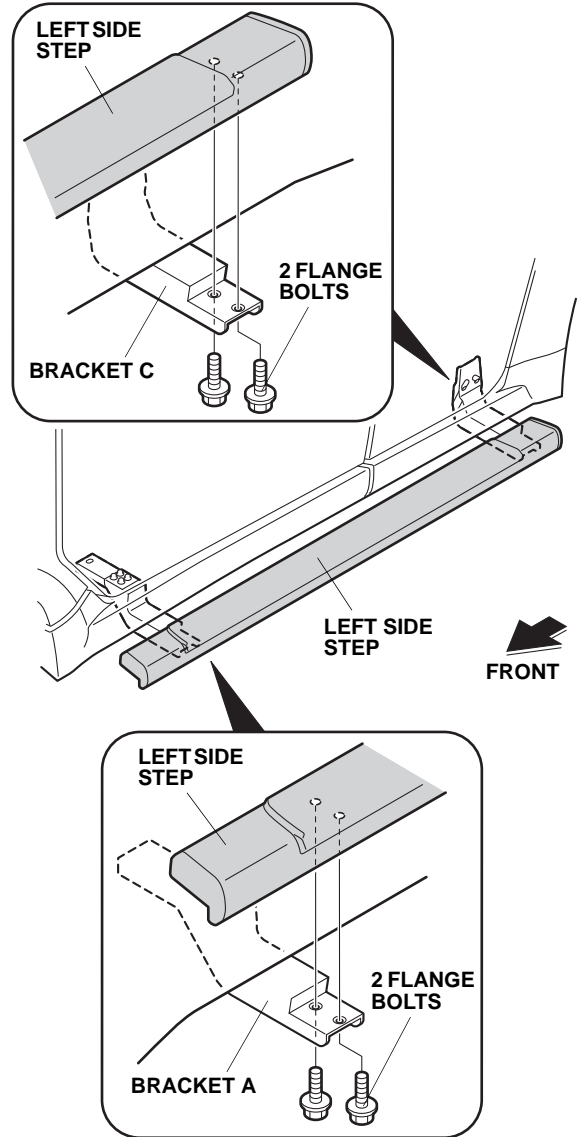

8. Torque the three flange bolts and four small flange nuts to 20.6 N·m (15.2 lbf-ft).

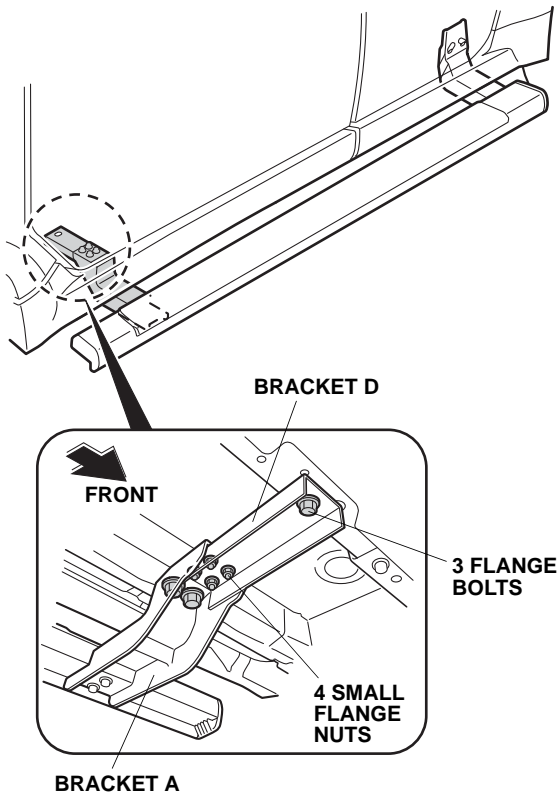

9. Align the left side step with the vehicle at an equal spacing.

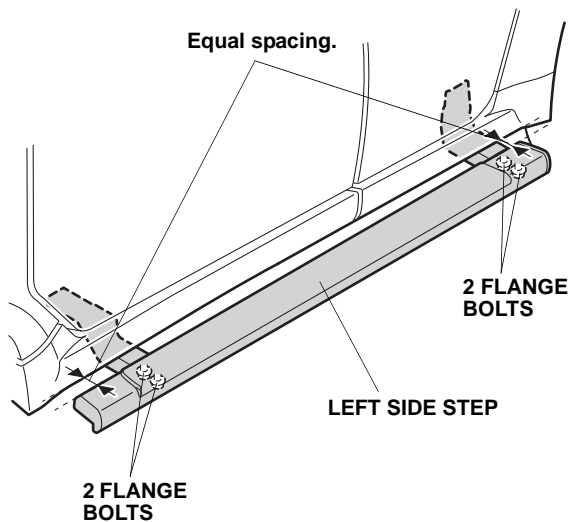

10. Torque the four flange bolts to 20.6 N·m (15.2 lbf-ft).  
11. Repeat steps 1 thru 10 to install the right side step.