



INSTALLATION INSTRUCTIONS

Accessory KEYLESS ENTRY P/N 08E60-SCV-100	Application ELEMENT	Publications No. All 24295
		Issue Date DEC 2002

PARTS LIST

2 Transmitters



Receiver unit

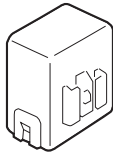

Bracket

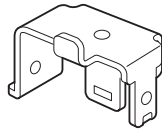

Flange bolt



Owner's manual

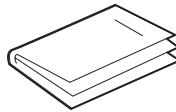

TOOLS REQUIRED

Ratchet

10 mm Socket

Illustration of the Keyless Entry Installed in the Vehicle

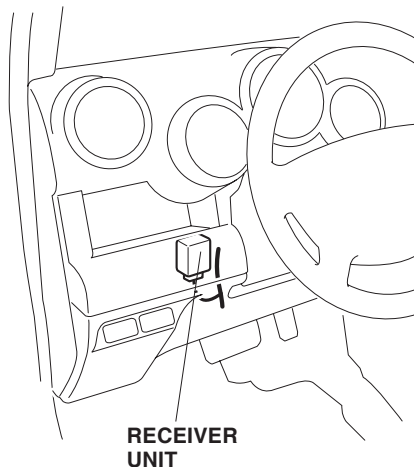

INSTALLATION

Customer Information: The information in this installation instruction is intended for use only by skilled technicians who have the proper tools, equipment, and training to correctly and safely add equipment to your vehicle. These procedures should not be attempted by "do-it-yourselfers."

1. If equipped, make sure you have the anti-theft code for the radio, then write down the frequencies for the preset buttons.
2. Disconnect the negative cable from the battery.
3. Remove the driver's dashboard lower cover, turn the knobs clockwise, then pull the driver's dashboard lower cover out toward you to release the six retaining tabs.

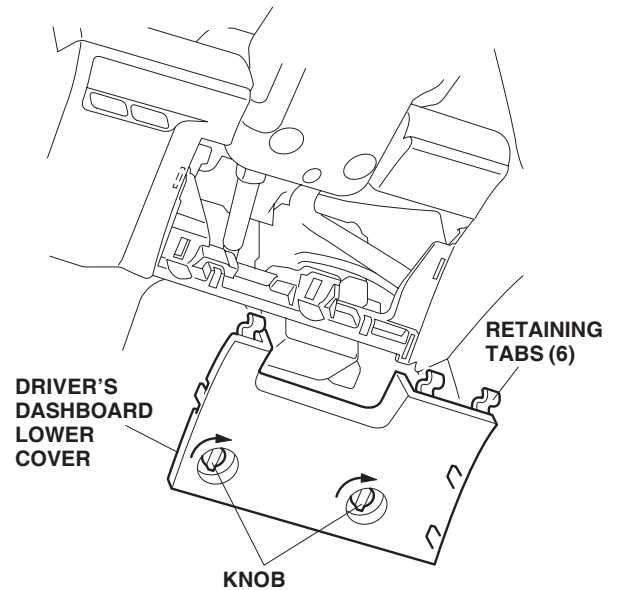

Note:

There will be a box inside the Element box that says "Civic" on it. The Civic and the Element use the same main control unit so Honda just reboxes the Civic unit with the required bracket for the Element.

- Slide the bracket onto the receiver unit. If the vehicle is equipped with an XM radio, refer to the XM radio installation instructions for the installation procedure to install the receiver unit.

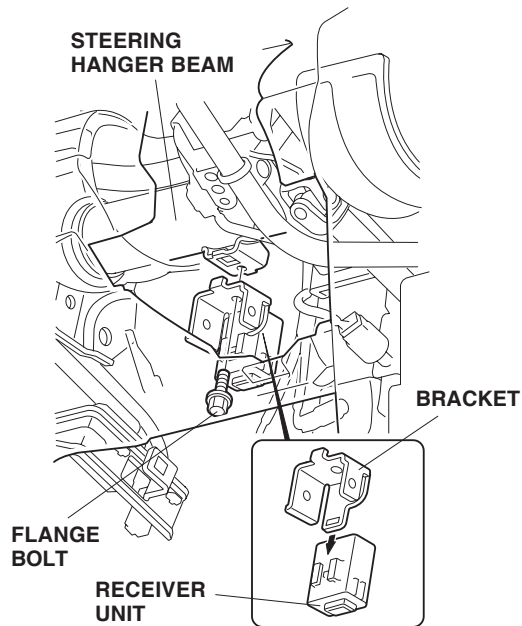

- Position the bracket on the steering hanger beam and install the flange bolt supplied.

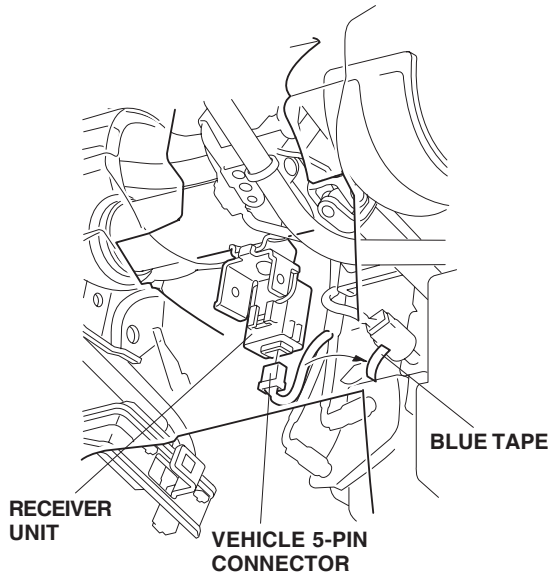

- Locate the 5-pin connector blue-taped to the vehicle harness and remove the blue tape to free the 5-pin connector. Plug the 5-pin connector into the receiver unit.

- Check that all wire harnesses and cables are routed properly and all connectors are plugged in.
 - Reinstall the driver's dashboard lower cover.
 - Reconnect the negative cable to the battery.
 - Enter the customer's radio anti-theft code, if applicable, and reset the radio station presets.
 - Reset the clock.
 - Check operation of the keyless entry according to the Owner's Manual supplied.
- NOTE:** Whenever the battery is disconnected, the driver's window AUTO function is disabled.
- Start the engine. Push down on the driver's window switch until the window is fully open.
 - Pull up on the driver's window switch to close the window completely, then hold the switch for 2 seconds.
 - Lower and raise the driver's window to check operation of the driver's window AUTO function.